

800SP210043

**ENGINEER'S CERTIFICATION**

\* I, DARRYL HAYTER being a Consulting Engineer and duly authorised representative of: - EMPOWER ENGINEERS & PROJECT MANAGERS Pty Ltd hereby:-

# certify the information contained in this drawing, prepared by DSQ survey Pty Ltd, is an accurate "as constructed" representation of the works;

# accept responsibility for the "as constructed" information contained in this drawing; and

# acknowledge the "as constructed" information contained in the drawing may be relied on by the UNITYWATER and other authorities.

Certification for Stage 1 by D. Hayter on 10/03/2020

For: EMPOWER ENGINEERS & PROJECT MANAGERS Pty Ltd

RPEQ No: 5694

**REGISTERED SURVEYOR'S CERTIFICATION**

I, Anthony Jon Pike hereby certify that the vertical and horizontal locations and dimensions shown on this plan are a true and correct record and were located by survey.

AB

Registered Surveyor (sig) Reg. Surveyor No. 52449 Date: 26.02.2020

Being a duly representative of:- DSQ SURVEY PTY LTD

**LEGEND**

- ⊕ MAINTENANCE SHAFT (#425 PP IPLEX EZPIT)
- ⊙ MAINTENANCE HOLE (#1050 PRECAST CONCRETE - HUMES)
- MAINTENANCE HOLE (#1200 PRECAST CONCRETE - HUMES)
- ⊙ EXISTING MAINTENANCE HOLE/SHAFT
- ⊠ HB1/1A LONG RADIUS BEND
- ⊠ WYE WYE JUNCTION (150x150 WITH 150x100 REDUCER)
- ⊠ RED REDUCER
- ⊠ E/1 BLANK END
- Reticulation Main (DN150 PVC-U SN8)
- House Connection (DN100 PVC-U SN10)
- - - EX\_S - - - EXISTING SEWER MAIN

**NOTE:**  
REFER TO SEQ-SEW-1104-1 FOR TYPICAL HOUSE CONNECTION DETAILS ON DUAL HOUSE CONNECTIONS

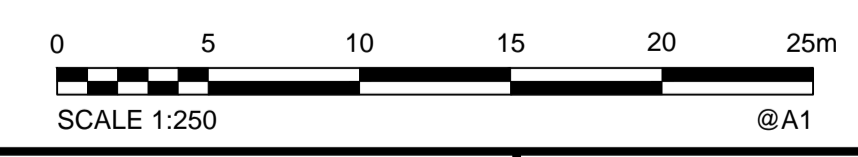
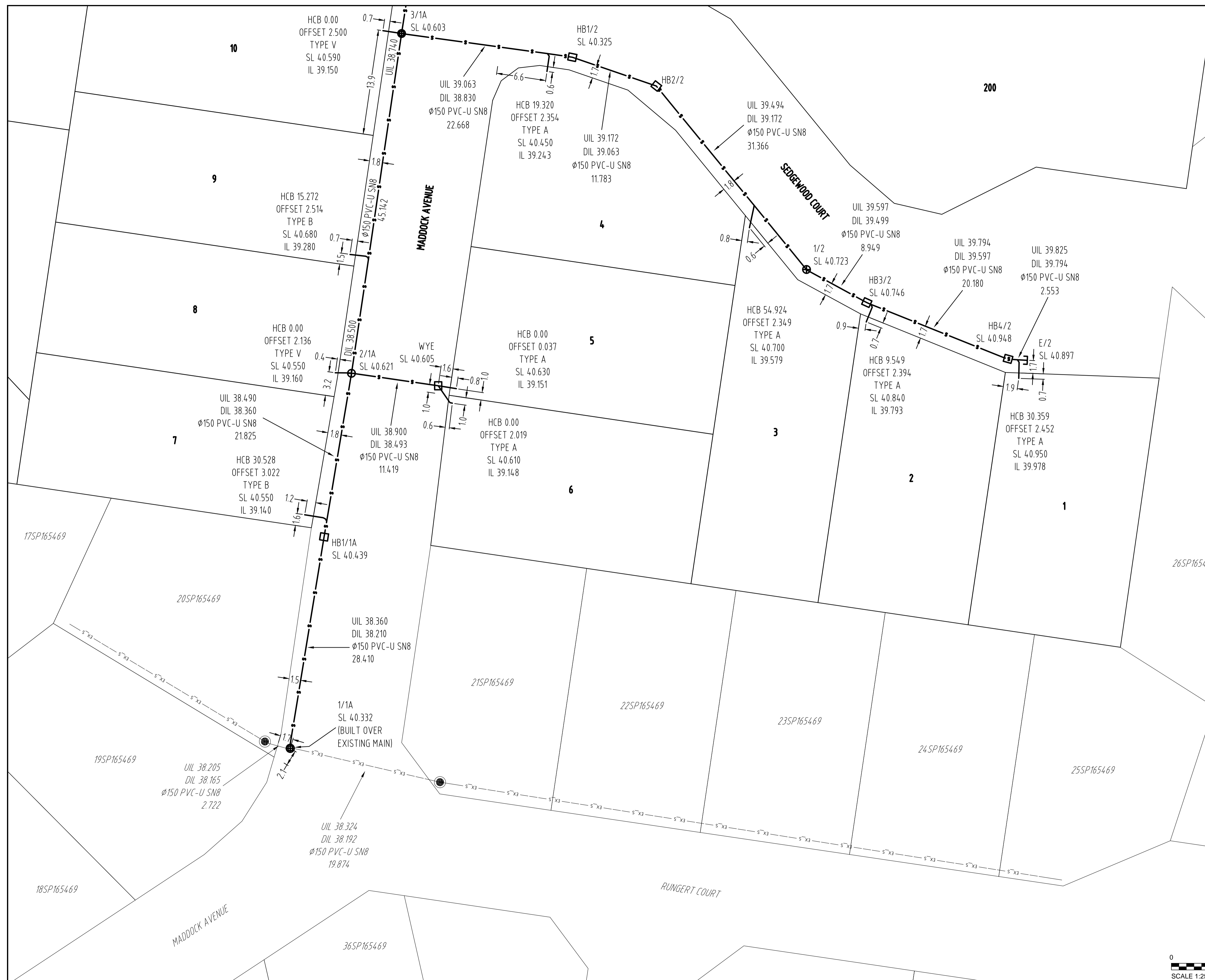

**AS CONSTRUCTED**

<b>A1</b>	C	10/03/2020	REVISIONS	BS	LG	DRAWN	BAS	13/12/2019
	B	26/02/2020	REVISIONS	BAS	LG	CHECKED	LG	13/12/2019
	A	13/12/2019	AS CONSTRUCTED	BAS	LG	PASSED		
	INDEX	DATE	REVISIONS	DRAWN	CHECKED	PASSED	INITIALS	DATE

**Empower**  
ENGINEERS & PROJECT MANAGERS  
ABN 23 010 743 692

**Unitywater**

**Unitywater**  
UW2017/011001-S1  
SEWERAGE RETICULATION AS CONSTRUCTED  
HILLSIDE MOOLOOLAH VALLEY STAGE 1  
MOOLOOLAH VALLEY

SHEET 1 OF 3 SHEETS	SCALE 1:250
REVISION DATE 10/03/2020	REVISION C
DISCIPLINE CODE	
DRAWING NO.	

**LEGEND**

- ⊕ MAINTENANCE SHAFT (#425 PP IPEX EZPT)
- ⊙ MAINTENANCE HOLE (#1050 PRECAST CONCRETE - HUMES)
- MAINTENANCE HOLE (#1200 PRECAST CONCRETE - HUMES)
- ⊙ EXISTING MAINTENANCE HOLE/SHAFT
- ▭ HB1/1A LONG RADIIUS BEND
- ▭ WYE WYE JUNCTION (150x150 WITH 150x100 REDUCER)
- ▭ RED REDUCER
- ▭ F/1 BLANK END
- RETICULATION MAIN (DN150 PVC-U SN8)
- HOUSE CONNECTION (DN100 PVC-U SN10)
- - - EX\_S - - - EX\_S - - - EXISTING SEWER MAIN

**NOTE:**  
REFER TO SEQ-SEW-1104-1 FOR TYPICAL HOUSE CONNECTION DETAILS ON DUAL HOUSE CONNECTIONS

**ENGINEER'S CERTIFICATION**  
 \* I, DARRYL HAYTER  
 being a Consulting Engineer and duly authorised representative of: -  
EMPOWER ENGINEERS & PROJECT MANAGERS Pty Ltd  
 hereby:-  
 # certify the information contained in this drawing, prepared by DSQ survey Pty Ltd, is an accurate "as constructed" representation of the works;  
 # accept responsibility for the "as constructed" information contained in this drawing; and  
 # acknowledge the "as constructed" information contained in the drawing may be relied on by the UNITYWATER and other authorities.  
 Certification for Stage 1 by D. Hayter on 10/03/2020  
 For: EMPOWER ENGINEERS & PROJECT MANAGERS Pty Ltd  
 RPEQ No: 5694

**REGISTERED SURVEYOR'S CERTIFICATION**  
 I, Antony Jon Pike, hereby certify that the vertical and horizontal locations and dimensions shown on this plan are a true and correct record and were located by survey.  
JB  
 Registered Surveyor (sig.) Reg. Surveyor No. 52449 Date: 26.02.2020  
 Being a duly representative of: - DSQ SURVEY PTY LTD

502SP308942

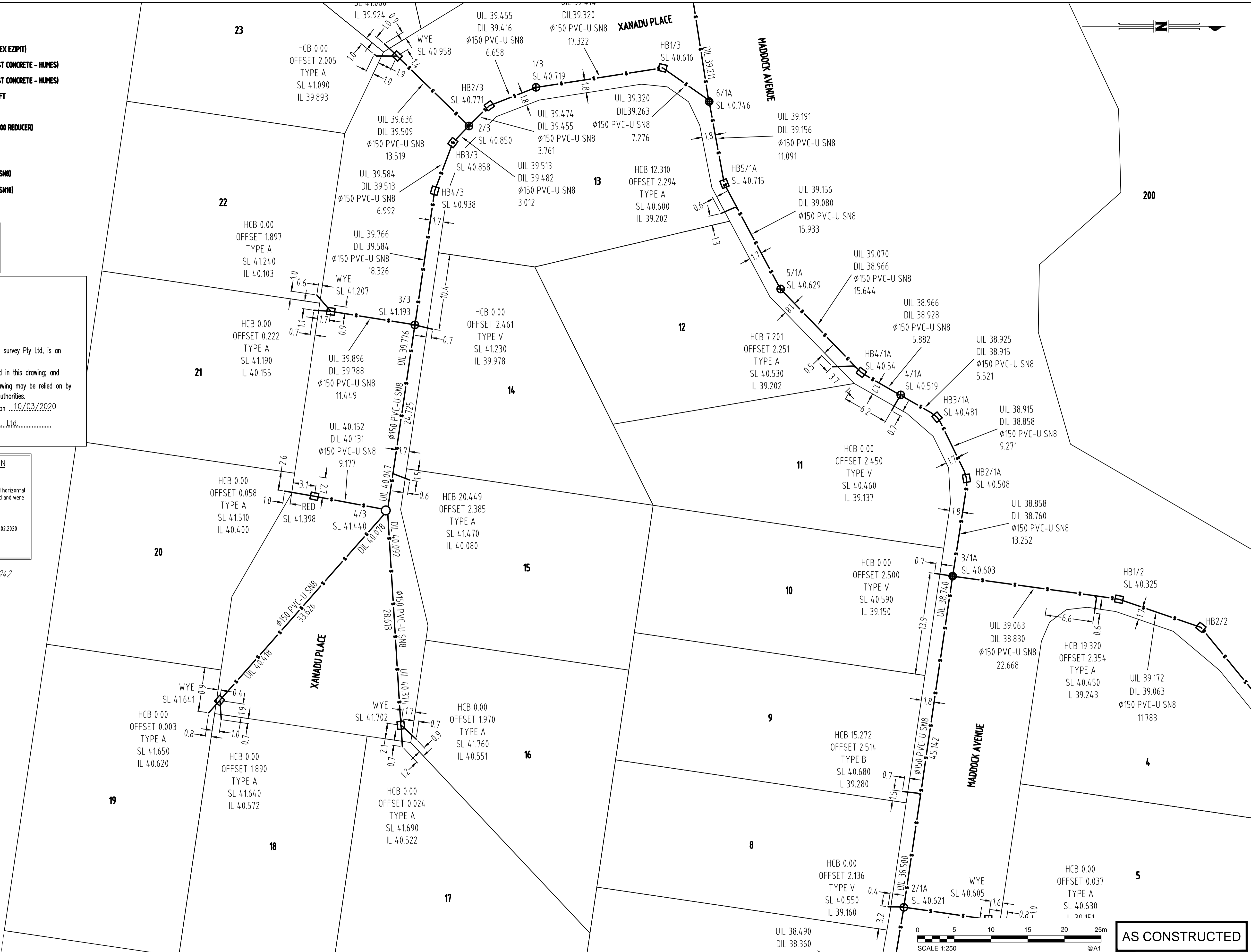

**AS CONSTRUCTED**

A1	C	10/03/2020	REVISIONS	BS	LG	DRAWN	BAS	13/12/2019
	B	26/02/2020	REVISIONS	BAS	LG	CHECKED	LG	13/12/2019
	A	13/12/2019	AS CONSTRUCTED	BAS	LG	PASSED		
	INDEX	DATE	REVISIONS	DRAWN	CHECKED	PASSED	INITIALS	DATE

**Empower**  
 ENGINEERS & PROJECT MANAGERS  
 ABN 23 010 743 692

**Unitywater**

**Unitywater**  
 UW2017/011001-S1  
 SEWERAGE RETICULATION AS CONSTRUCTED  
 HILLSIDE MOOLOOLAH VALLEY STAGE 1  
 MOOLOOLAH VALLEY

SHEET 2 OF 3	SHEETS	SCALE 1:250
REVISION DATE	10/03/2020	REVISION C
DISCIPLINE CODE		
DRAWING NO.		

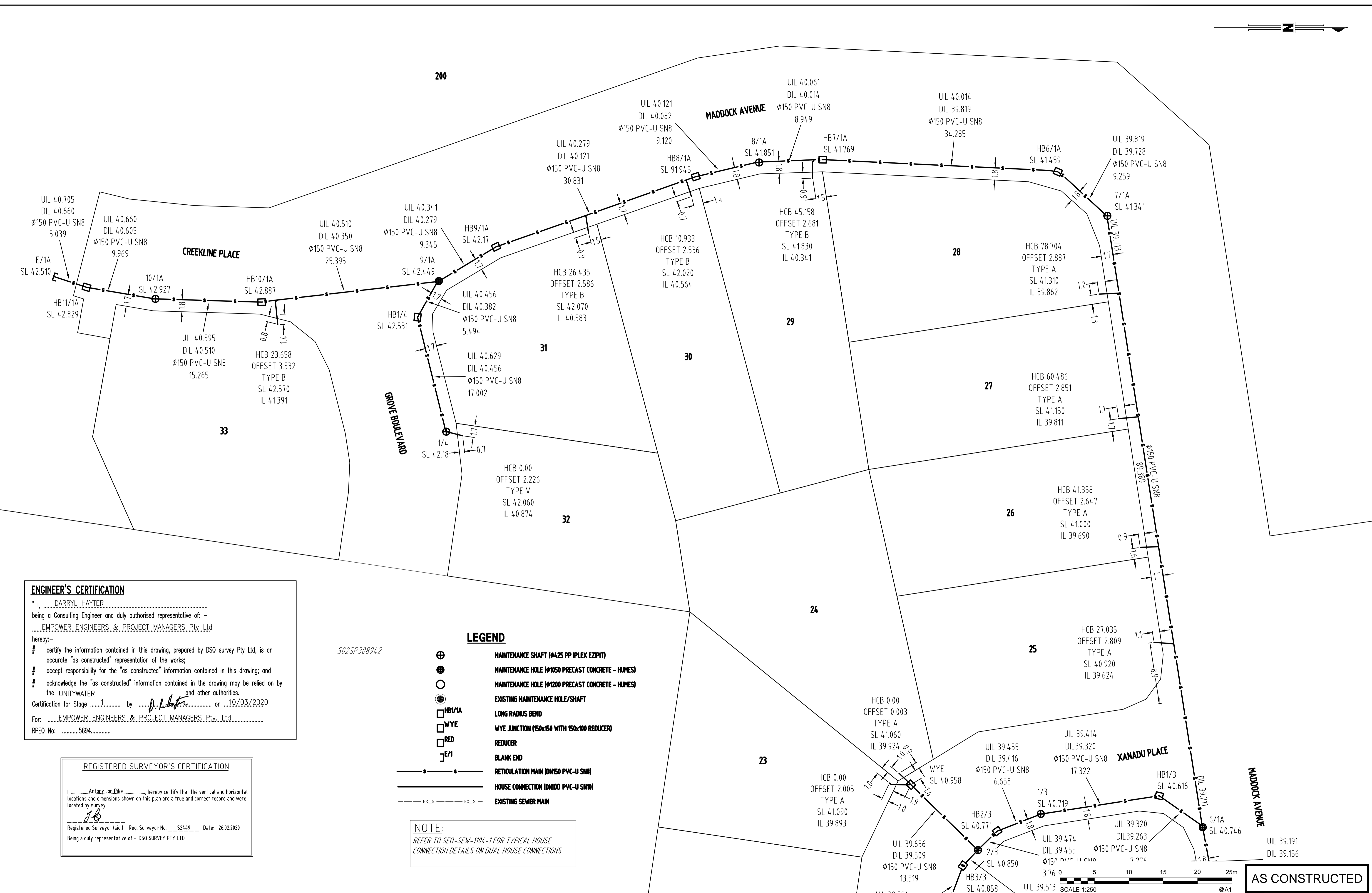
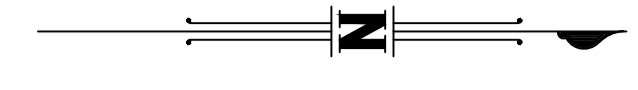

**ENGINEER'S CERTIFICATION**  
 \* I, DARRYL HAYTER  
 being a Consulting Engineer and duly authorised representative of: -  
EMPOWER ENGINEERS & PROJECT MANAGERS Pty Ltd  
 hereby:-  
 # certify the information contained in this drawing, prepared by DSQ survey Pty Ltd, is an accurate "as constructed" representation of the works;  
 # accept responsibility for the "as constructed" information contained in this drawing; and  
 # acknowledge the "as constructed" information contained in the drawing may be relied on by the UNITYWATER and other authorities.  
 Certification for Stage 1 by D. Hayter on 10/03/2020  
 For: EMPOWER ENGINEERS & PROJECT MANAGERS Pty Ltd  
 RPEQ No: 5694

502SP308942

**LEGEND**

- MAINTENANCE SHAFT (Ø425 PP IPEX EZIPIT)
- MAINTENANCE HOLE (Ø1050 PRECAST CONCRETE - HUMES)
- MAINTENANCE HOLE (Ø1200 PRECAST CONCRETE - HUMES)
- EXISTING MAINTENANCE HOLE/SHAFT
- LONG RADIUS BEND
- WYE JUNCTION (150x150 WITH 150x100 REDUCER)
- REDUCER
- BLANK END
- RETICULATION MAIN (DN150 PVC-U SN8)
- HOUSE CONNECTION (DN100 PVC-U SN8)
- EXISTING SEWER MAIN

**NOTE:**  
 REFER TO SEQ-SEW-1104-1 FOR TYPICAL HOUSE CONNECTION DETAILS ON DUAL HOUSE CONNECTIONS

**REGISTERED SURVEYOR'S CERTIFICATION**  
 I, Anthony Jon Pike, hereby certify that the vertical and horizontal locations and dimensions shown on this plan are a true and correct record and were located by survey.  
JB  
 Registered Surveyor (sig.) Reg. Surveyor No. S2449 Date: 26/02/2020  
 Being a duly representative of:- DSQ SURVEY PTY LTD

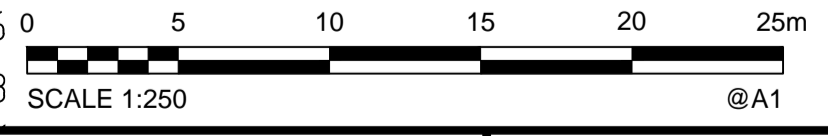

**AS CONSTRUCTED**

<b>A1</b>	C	10/03/2020	REVISIONS	BAS	LG	DRAWN	BAS	13/12/2019
	B	26/02/2020	REVISIONS	BAS	LG	CHECKED	LG	13/12/2019
	A	13/12/2019	AS CONSTRUCTED	BAS	LG	PASSED		
	INDEX	DATE	REVISIONS	DRAWN	CHECKED	PASSED	INITIALS	DATE



**Unitywater**  
 UW2017/011001-S1  
 SEWERAGE RETICULATION AS CONSTRUCTED  
 HILLSIDE MOOLOOLAH VALLEY STAGE 1  
 MOOLOOLAH VALLEY

SHEET 3 OF 3	SHEETS	SCALE 1:250
REVISION DATE	10/03/2020	REVISION C
DISCIPLINE CODE		
DRAWING NO.		