







LEGEND

-  MAINTENANCE SHAFT (Ø425 PP IPLEX EZIPIT)
-  MAINTENANCE HOLE (HUMES Ø1050 PRECAST CONCRETE)
-  BEND
-  LONG RADIUS BEND
-  WYE JUNCTION (150x150 WITH 150x100 REDUCER)
-  150x100 REDUCER
-  RETICULATION MAIN (DN150 PVC-U SN8)
-  HOUSE CONNECTION (DN100 PVC-U SN10)

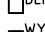
NOTE:
REFER TO SEQ-SEW-1104-1 FOR TYPICAL HOUSE CONNECTION DETAILS ON DUAL HOUSE CONNECTIONS

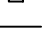
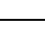
ENGINEER'S CERTIFICATION - UNITYWATER REF. 201701100152 ACP
 I, DARRYL HAYTER
 being a Consulting Engineer and duly authorised representative of: -
 EMPOWER ENGINEERS AND PROJECT MANAGERS
 hereby:-
 certify the information contained in this drawing, prepared by DSQ SURVEY PTY LTD, is an accurate "as constructed" representation of the works;
 accept responsibility for the "as constructed" information contained in this drawing; and
 acknowledge the "as constructed" information contained in the drawing may be relied on by the UNITYWATER and others.
 Certification for Stage 2 by D.H. on 07.06.22
 For: EMPOWER ENGINEERS AND PROJECT MANAGERS PRCO 5694

REGISTERED SURVEYOR'S CERTIFICATION
 I, Antony Jan Pike, hereby certify that the vertical and horizontal locations and dimensions shown on this plan are a true and correct record and were located by survey.
 Registered Surveyor (sig.) Reg. Surveyor No. 52449 Date: 06.06.22

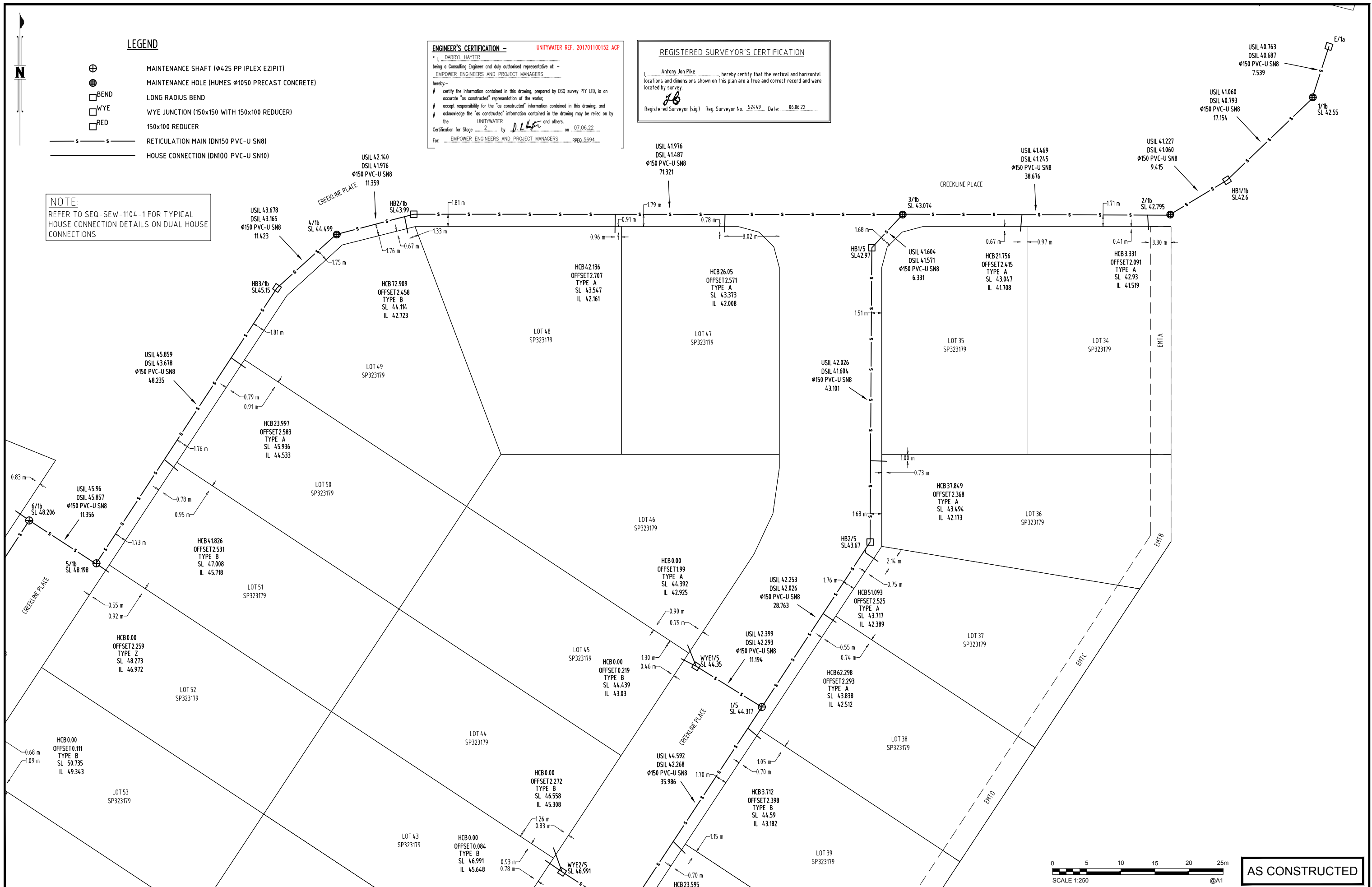

0 5 10 15 20 25m
 SCALE 1:250 @A1

AS CONSTRUCTED

A1	0	06/06/2022	AS CONSTRUCTED DETAILS	BR	LG	
	INDEX	DATE	REVISIONS	DRAWN	CHECKED	PASSED

DRAWN	BR	06/06/2022
CHECKED	LG	06/06/2022
PASSED		
INITIALS	DATE	

Empower
 ENGINEERS & PROJECT MANAGERS
 ABN 23 010 743 692

Unitywater

Unitywater
 UW201701100152
 SEWER RETICULATION WORKS
 HILLSIDE STAGE 2
 MOOLOOLAH VALLEY

SHEET 3 OF 4 SHEETS	SCALE 1:250
REVISION DATE 06/06/2022	REVISION 0
DISCIPLINE CODE C	
DRAWING NO.	

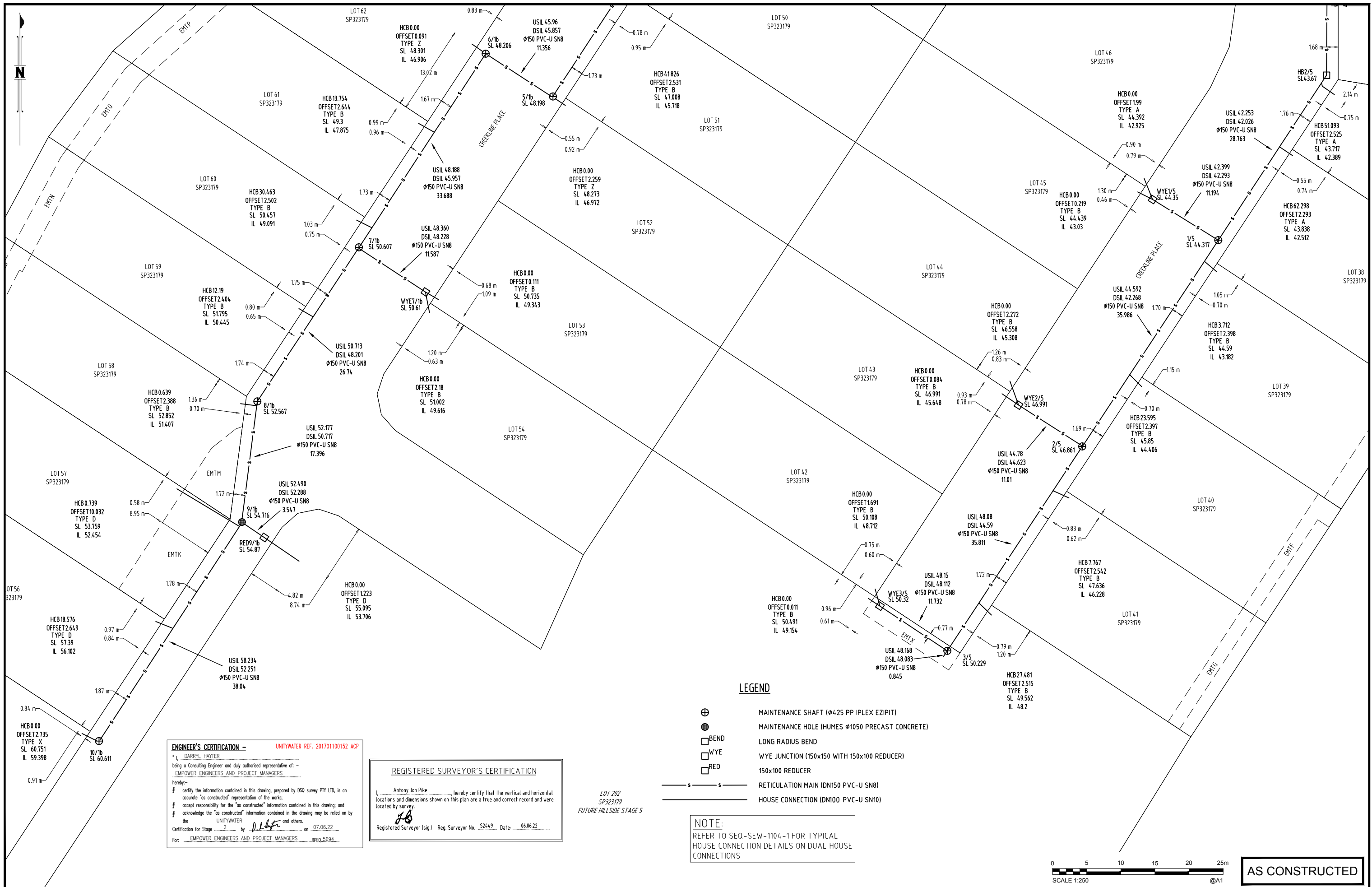

ENGINEER'S CERTIFICATION - UNITYWATER REF. 201701100152 ACP
 I, DARRYL HAYTER
 being a Consulting Engineer and duly authorised representative of: -
EMPOWER ENGINEERS AND PROJECT MANAGERS
 hereby:-
 # certify the information contained in this drawing, prepared by DSQ survey PTY LTD, is an accurate "as constructed" representation of the works;
 # accept responsibility for the "as constructed" information contained in this drawing; and
 # acknowledge the "as constructed" information contained in the drawing may be relied on by the UNITYWATER and others.
 Certification for Stage 2 by D.H. on 07.06.22
 For: EMPOWER ENGINEERS AND PROJECT MANAGERS RPEQ 5694

REGISTERED SURVEYOR'S CERTIFICATION
 I, Antony Jon Pike, hereby certify that the vertical and horizontal locations and dimensions shown on this plan are a true and correct record and were located by survey.
JB
 Registered Surveyor (sig) Reg. Surveyor No. 52449 Date: 06.06.22

LOT 202
 SP323179
 FUTURE HILLSIDE STAGE 5

LEGEND

- ⊕ MAINTENANCE SHAFT (Ø425 PP IPELEX EZIPIT)
- ⊙ MAINTENANCE HOLE (HUMES Ø1050 PRECAST CONCRETE)
- BEND LONG RADIUS BEND
- WYE WYE JUNCTION (150x150 WITH 150x100 REDUCER)
- RED 150x100 REDUCER
- s — s — RETICULATION MAIN (DN150 PVC-U SN8)
- HOUSE CONNECTION (DN100 PVC-U SN10)

NOTE:
 REFER TO SEQ-SEW-1104-1 FOR TYPICAL HOUSE CONNECTION DETAILS ON DUAL HOUSE CONNECTIONS

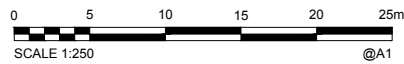

AS CONSTRUCTED

A1	0	06/06/2022	AS CONSTRUCTED DETAILS	BR	LG	PASSED			
	INDEX	DATE	REVISIONS	DRAWN	CHECKED	PASSED	INITIALS	DATE	

Empower ENGINEERS & PROJECT MANAGERS
 ABN 23 010 743 692



Unitywater
 UW201701100152
 SEWER RETICULATION WORKS
 HILLSIDE STAGE 2
 MOOLOOLAH VALLEY

SHEET 3 OF 4 SHEETS	SCALE 1:250
REVISION DATE 06/06/2022	REVISION 0
DISCIPLINE CODE C	
DRAWING NO.	