

Scale 1:400 - Lengths are in Metres.

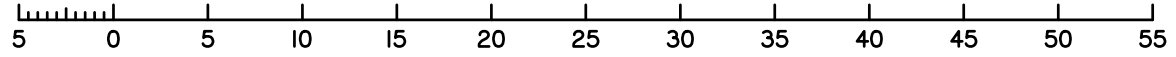

**DISCLOSURE PLAN**  
**FOR PROPOSED ALLOTMENT 401**  
 Dated 26th April 2022

This plan shows details of proposed allotment 401 on the Proposal Plan PL204-E dated 26th June 2019 which complies with a Subdivision Application lodged with Sunshine Coast Regional Council, subject to conditions.

The area being proposed allotment 401 described as part of Lot 3 on RP158360 & Lot 201 on SP323179, and situated at King Road, Mooloolah Valley.  
 The allotment contains an area of 1002 square metres, more or less.

DETAIL SURVEY COMPLETED BY VERIS  
 PLAN 32267-DS01 Rev B 28/11/2018.  
 ENGINEERING DESIGN BY EMPOWER  
 ENGINEERS & PROJECT MANAGERS  
 X-B00336 St4-Design  
 DATED 22/04/2022.

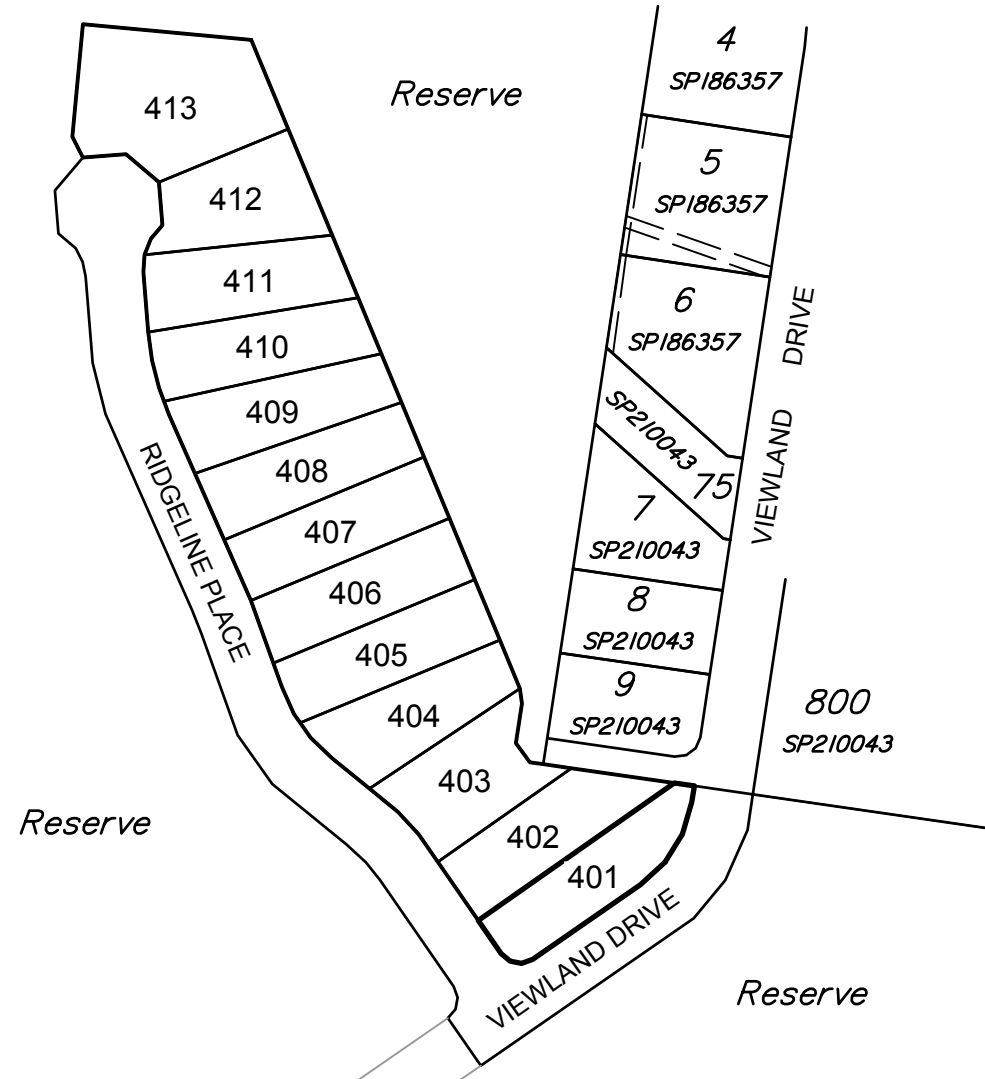

Scale 1:2000 - Lengths are in Metres.

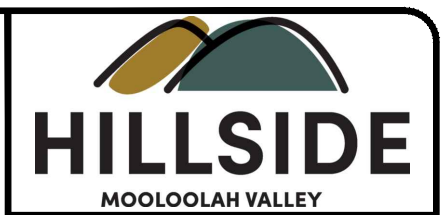
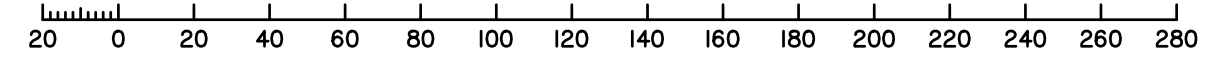

**Disclosure Plan**  
**STAGE 4**  
**HILLSIDE**  
**MOOLOOLAH**  
**King Road, Mooloolah**  
**PROPOSED LOT 401**

ALL FILL WITHIN ALLOTMENTS IS TO LEVEL 1 INSPECTION AND TESTING IN ACCORDANCE WITH AS3798-2007

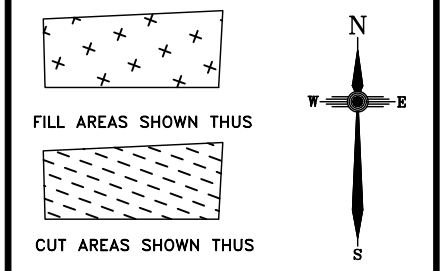

**Note**  
 Contour interval is shown at 0.5 metres.

Revisions	Surveyed	Drawn	Checked	Passed	Date	
C	BFZ REMOVED	VERIS	JJ	AJP	AJP	09.04.24
B	BFZ DIMS	VERIS	JJ	AJP	AJP	28.04.23
A	ORIGINAL PLAN	VERIS	JJ	AJP	AJP	26.04.22

**DSQ**  
**LAND SURVEYORS**  
 SUNSHINE COAST  
 PO Box 1073, Buddina QLD 4575 Ph: (07) 5437 8555  
 mail@dsqsurvey.com ABN: 91 615 043 251  
 www.dsqsurvey.com ACN: 615 043 251  
 WESTERN DOWNS

Signed JB  
 Cadastral Surveyor/Director  
 Date 26/04/2022

Horiz. Datum MGA Z56 Vert. Datum AHD  
 Origin MGA Origin PSM 157803  
 RL 39.695 AHD

Locality: MOOLOOLAH VALLEY  
 Local Government: SUNSHINE COAST REGIONAL COUNCIL

SHEET 1 OF 1 Scale At A3 size  
 COMPUTER FILE 14368 DIS St4 Rev C  
 DRAWING NUMBER 14368 DIS-401 REV. C

2024/04/09W: DSQ\_Data\Jobs\Current\14368 Urban (Mooloolah Stages 3 & 4)\Data Survey\Drafting\Disclosures\14368 DIS St4 Rev C.dwg

**Disclosure Plan**  
**STAGE 4**  
**HILLSIDE**  
**MOOLOOLAH**  
**King Road, Mooloolah**  
**PROPOSED LOT 402**

**DISCLOSURE PLAN**  
**FOR PROPOSED ALLOTMENT 402**  
 Dated 26th April 2022

This plan shows details of proposed allotment 402 on the Proposal Plan PL204-E dated 26th June 2019 which complies with a Subdivision Application lodged with Sunshine Coast Regional Council, subject to conditions.

The area being proposed allotment 402 described as part of Lot 3 on RP158360 & Lot 201 on SP323179, and situated at King Road, Mooloolah Valley.  
 The allotment contains an area of 1002 square metres, more or less.

ALL FILL WITHIN ALLOTMENTS IS TO LEVEL 1 INSPECTION AND TESTING IN ACCORDANCE WITH AS3798-2007

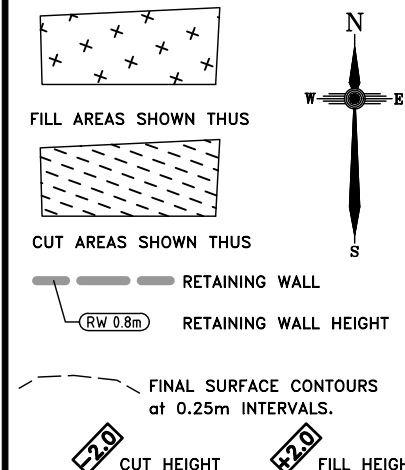

**Note**  
 Contour interval is shown at 0.5 metres.

Revisions	Surveyed	Drawn	Checked	Passed	Date	
C	BFZ REMOVED	VERIS	JJ	AJP	AJP	09.04.24
B	BFZ DIMS	VERIS	JJ	AJP	AJP	28.04.23
A	ORIGINAL PLAN	VERIS	JJ	AJP	AJP	26.04.22



SUNSHINE COAST  
 PO Box 1073, Buddina QLD 4575 Ph: (07) 5437 8555  
 mail@dsqsurvey.com ABN: 91 615 043 251  
 www.dsqsurvey.com ACN: 615 043 251  
 WESTERN DOWNS

Signed   
 Cadastral Surveyor/Director  
 Date **26/04/2022**

Horiz. Datum MGA Z56 Vert. Datum AHD  
 Origin MGA Origin PSM 157803  
 RL 39.695 AHD

Locality: MOOLOOLAH VALLEY

Local Government: SUNSHINE COAST REGIONAL COUNCIL

SHEET 1 OF 1 Scale At A3 size

COMPUTER FILE 14368 DIS S14 Rev C  
 DRAWING NUMBER 14368 DIS-402 REV. C

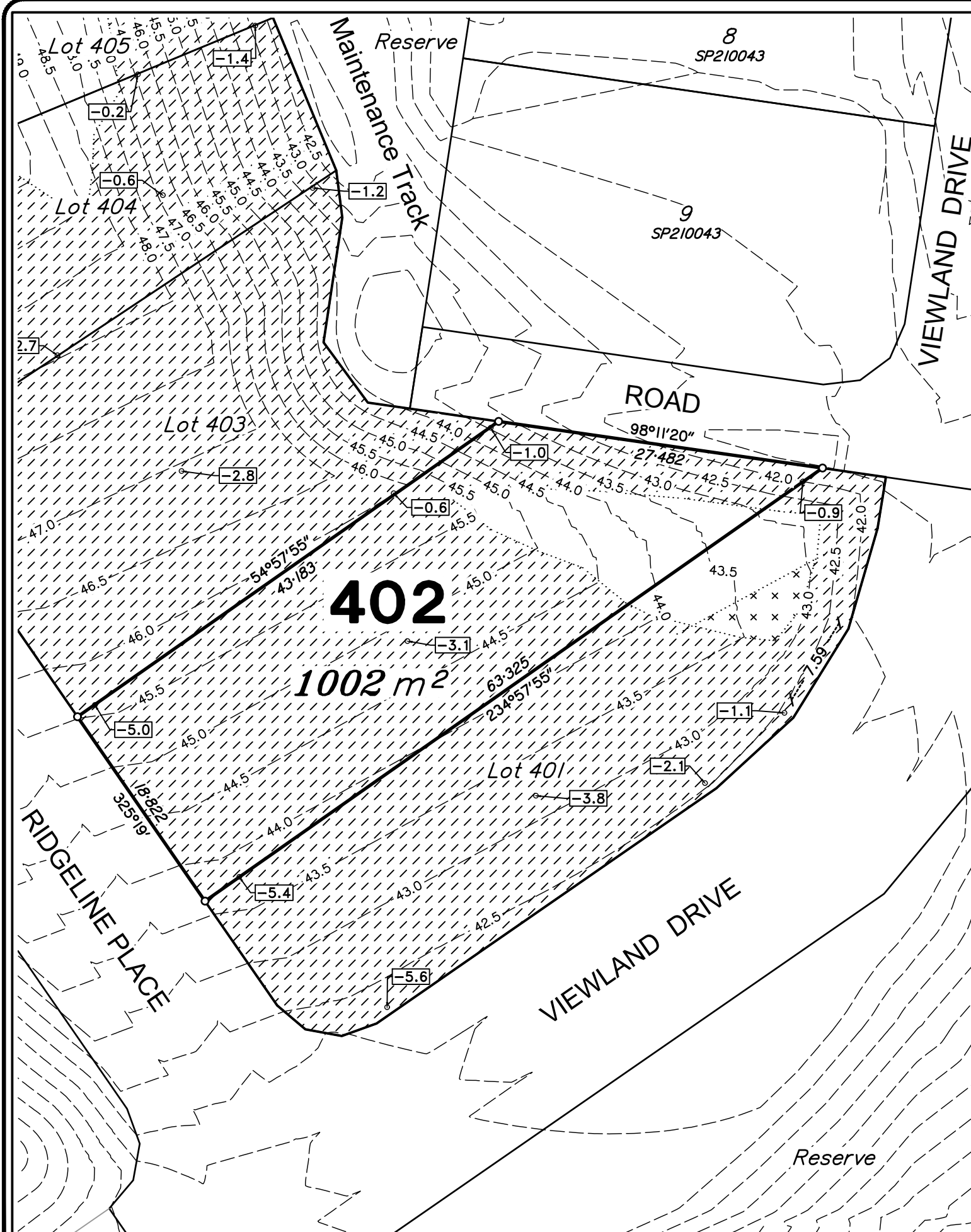

Scale 1:400 - Lengths are in Metres.

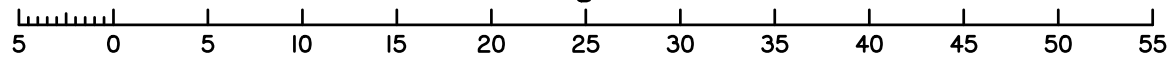

DETAIL SURVEY COMPLETED BY VERIS  
 PLAN 32267-DS01 Rev B 28/11/2018.  
 ENGINEERING DESIGN BY EMPOWER  
 ENGINEERS & PROJECT MANAGERS  
 X-B00336 S14-Design  
 DATED 22/04/2022.

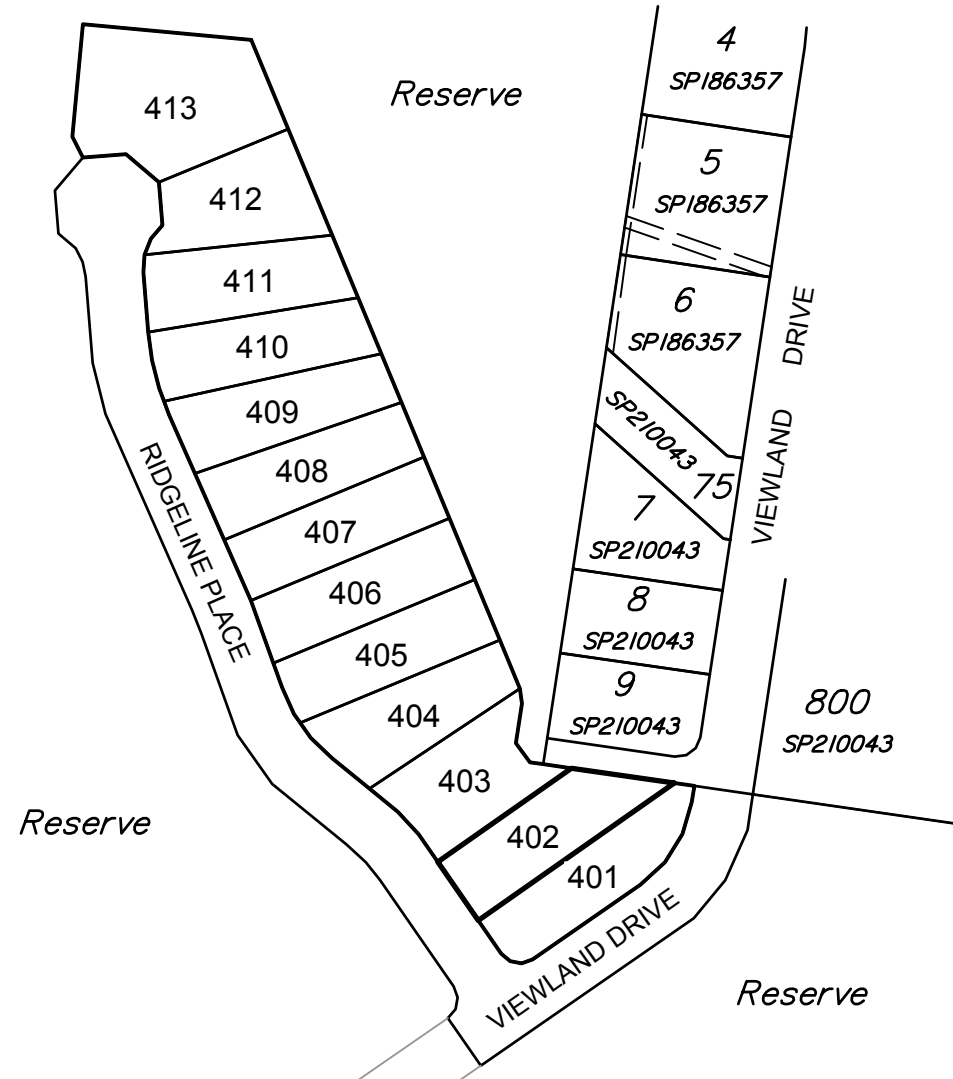

Scale 1:2000 - Lengths are in Metres.

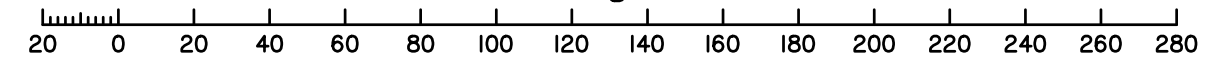

2024/04/09W: DSQ\_Data\Jobs\Current\14368 Urban (Mooloolah Stages 3 & 4)\Data Survey\Drafting\Disclosures\14368 DIS S14 Rev C.dwg



**Disclosure Plan**  
**STAGE 4**  
**HILLSIDE**  
**MOOLOOLAH**  
King Road, Mooloolah  
**PROPOSED LOT 403**

ALL FILL WITHIN ALLOTMENTS IS TO LEVEL 1 INSPECTION AND TESTING IN ACCORDANCE WITH AS3798-2007

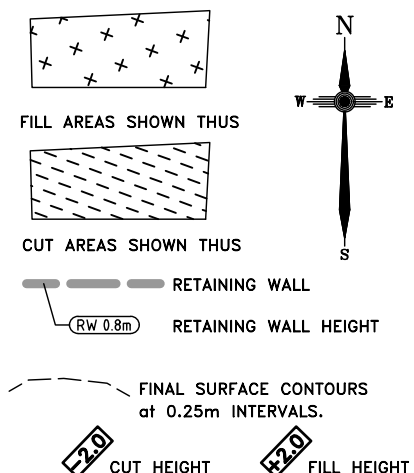

**Note**  
Contour interval is shown at 0.5 metres.

Revisions	Surveyed	Drawn	Checked	Passed	Date	
C	BFZ REMOVED	VERIS	JJ	AJP	AJP	09.04.24
B	BFZ DIMS	VERIS	JJ	AJP	AJP	28.04.23
A	ORIGINAL PLAN	VERIS	JJ	AJP	AJP	28.04.22



SUNSHINE COAST  
PO Box 1073, Buddina QLD 4575 Ph: (07) 5437 8555  
mail@dqsurvey.com ABN: 91 615 043 251  
www.dqsurvey.com ACN: 615 043 251  
WESTERN DOWNS

Signed JB  
Cadastral Surveyor/Director  
Date 26/04/2022

Horiz. Datum MGA Z56 Vert. Datum AHD  
Origin MGA Origin PSM 157803  
RL 39.695 AHD

Locality: MOOLOOLAH VALLEY

Local Government: SUNSHINE COAST REGIONAL COUNCIL

SHEET 1 OF 1 Scale At A3 size

COMPUTER FILE 14368 DIS S14 Rev C

DRAWING NUMBER REV.  
**14368 DIS-403** **C**

**DISCLOSURE PLAN**  
**FOR PROPOSED ALLOTMENT 403**  
Dated 26th April 2022

This plan shows details of proposed allotment 403 on the Proposal Plan PL204-E dated 26th June 2019 which complies with a Subdivision Application lodged with Sunshine Coast Regional Council, subject to conditions.

The area being proposed allotment 403 described as part of Lot 3 on RP158360 & Lot 201 on SP323179, and situated at King Road, Mooloolah Valley.  
The allotment contains an area of 1015 square metres, more or less.

DETAIL SURVEY COMPLETED BY VERIS  
PLAN 32267-DS01 Rev B 28/11/2018.  
ENGINEERING DESIGN BY EMPOWER  
ENGINEERS & PROJECT MANAGERS  
X-B00336 S14-Design  
DATED 22/04/2022.

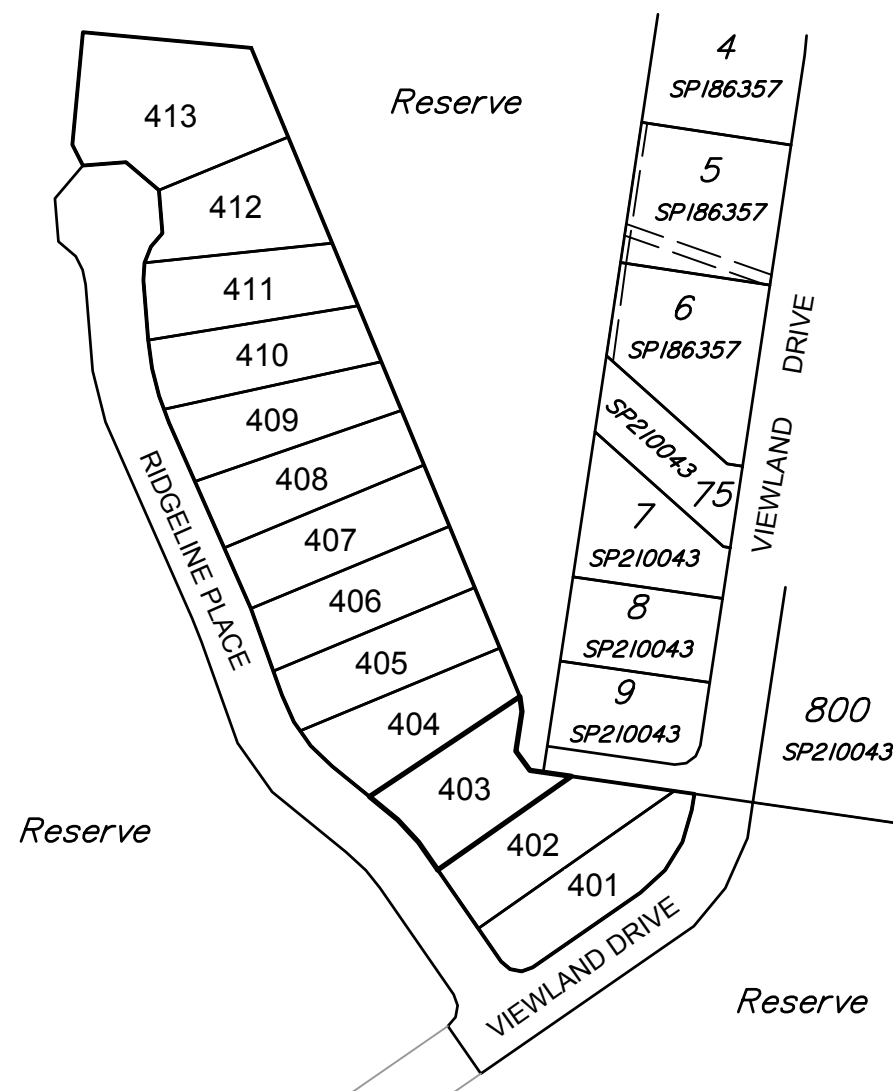

Scale 1:2000 - Lengths are in Metres.

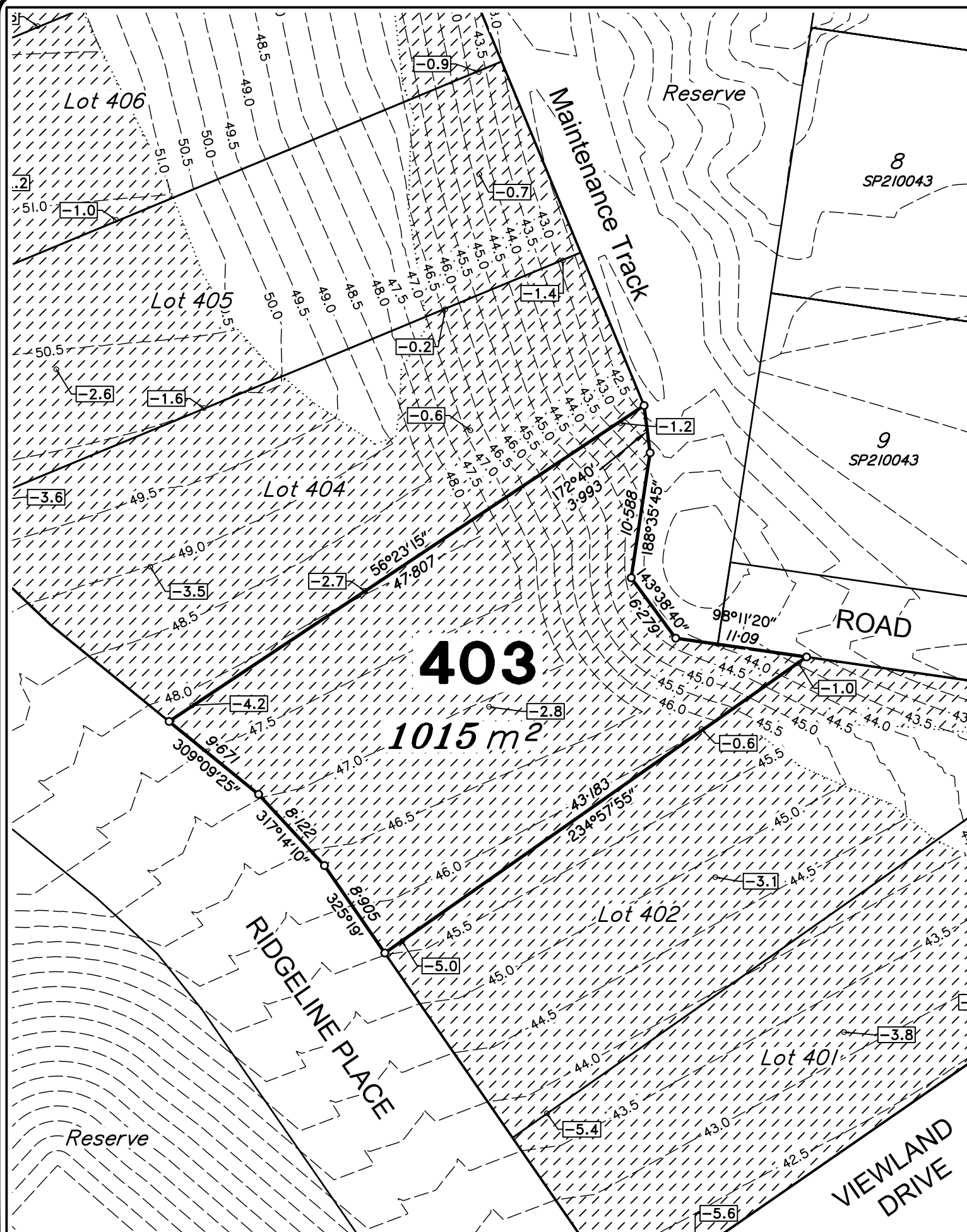
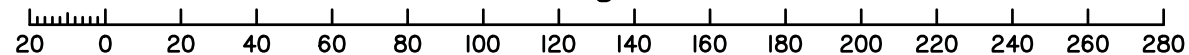

Scale 1:400 - Lengths are in Metres.

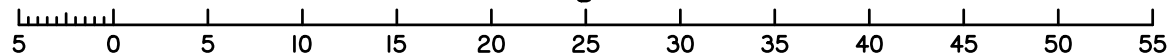

2024/04/09W: DSO\_Data \Jobs \Current \4368 Urban \Mooloolah Stages 3 & 4 \Data Survey \Drafting \Disclosures \4368 DIS S14 Rev C.dwg

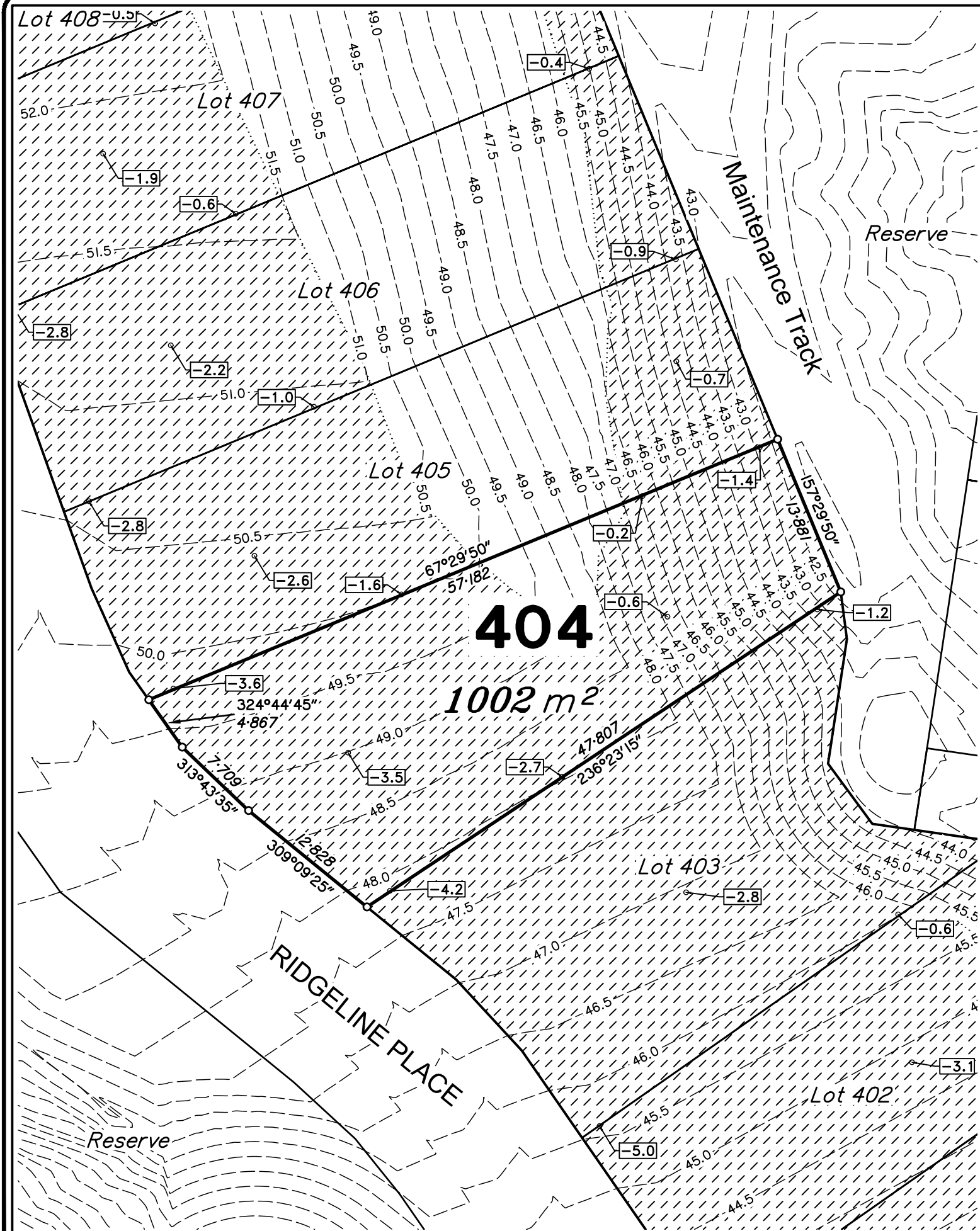

Scale 1:400 - Lengths are in Metres.

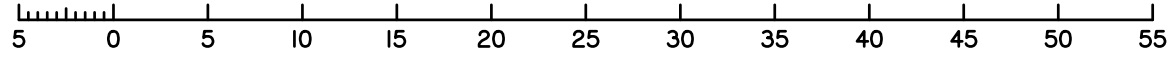

**DISCLOSURE PLAN**  
**FOR PROPOSED ALLOTMENT 404**  
 Dated 26th April 2022

This plan shows details of proposed allotment 404 on the Proposal Plan PL204-E dated 26th June 2019 which complies with a Subdivision Application lodged with Sunshine Coast Regional Council, subject to conditions.

The area being proposed allotment 404 described as part of Lot 3 on RP158360 & Lot 201 on SP323179, and situated at King Road, Mooloolah Valley.  
 The allotment contains an area of 1002 square metres, more or less.

DETAIL SURVEY COMPLETED BY VERIS  
 PLAN 32267-DS01 Rev B 28/11/2018.  
 ENGINEERING DESIGN BY EMPOWER  
 ENGINEERS & PROJECT MANAGERS  
 X-B00336 St4-Design  
 DATED 22/04/2022.

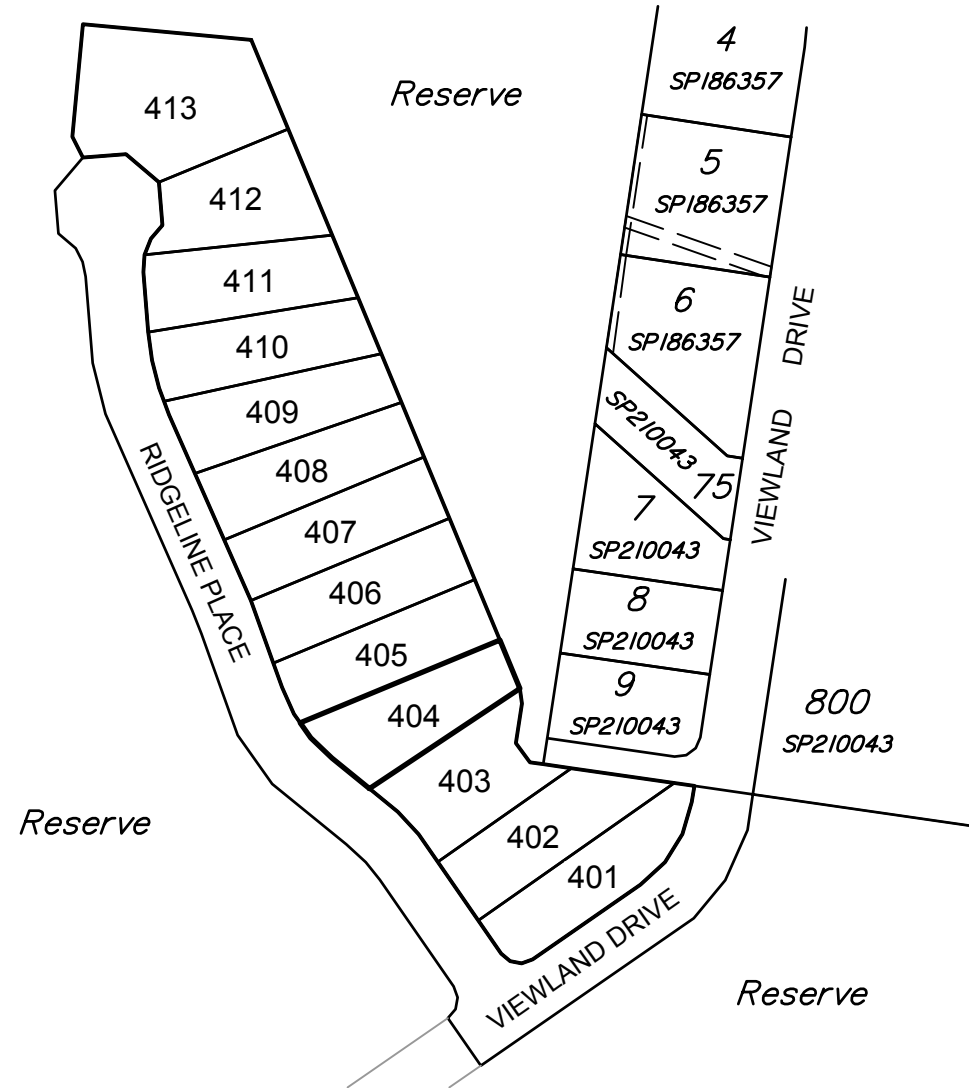

Scale 1:2000 - Lengths are in Metres.

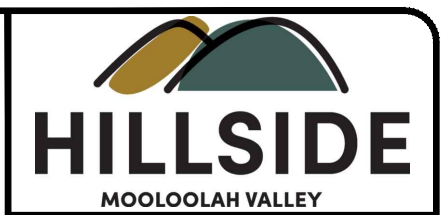
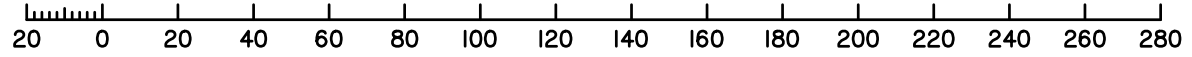

**Disclosure Plan**  
**STAGE 4**  
**HILLSIDE**  
**MOOLOOLAH**  
**King Road, Mooloolah**  
**PROPOSED LOT 404**

ALL FILL WITHIN ALLOTMENTS IS TO LEVEL 1 INSPECTION AND TESTING IN ACCORDANCE WITH AS3798-2007

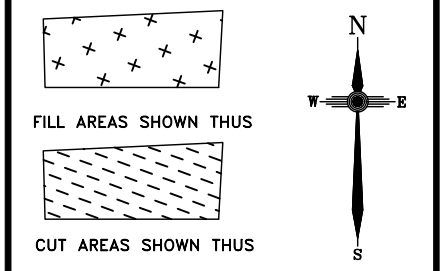

FINAL SURFACE CONTOURS at 0.25m INTERVALS.  
 CUT HEIGHT  
 FILL HEIGHT

Note  
 Contour interval is shown at 0.5 metres.

Revisions	Surveyed	Drawn	Checked	Passed	Date	
C	BFZ REMOVED	VERIS	JJ	AJP	AJP	09.04.24
B	BFZ DIMS	VERIS	JJ	AJP	AJP	28.04.23
A	ORIGINAL PLAN	VERIS	JJ	AJP	AJP	26.04.22



SUNSHINE COAST  
 PO Box 1073, Buddina QLD 4575 Ph: (07) 5437 8555  
 mail@dsqsurvey.com ABN: 91 615 043 251  
 www.dsqsurvey.com ACN: 615 043 251  
 WESTERN DOWNS

Signed JB  
 Cadastral Surveyor/Director  
 Date 26/04/2022

Horiz. Datum MGA Z56 Vert. Datum AHD  
 Origin MGA Origin PSM 157803  
 RL 39.695 AHD

Locality: MOOLOOLAH VALLEY

Local Government: SUNSHINE COAST REGIONAL COUNCIL

SHEET 1 OF 1 Scale At A3 size

COMPUTER FILE 14368 DIS S14 Rev C  
 DRAWING NUMBER 14368 DIS-404 REV. C

2024/04/09W: DSQ\_Data\Jobs\Current\14368 Urban (Mooloolah Stages 3 & 4)\Data Survey\Drafting\Disclosures\14368 DIS S14 Rev C.dwg



**Disclosure Plan**  
**STAGE 4**  
**HILLSIDE**  
**MOOLOOLAH**  
King Road, Mooloolah  
**PROPOSED LOT 405**

ALL FILL WITHIN ALLOTMENTS IS TO LEVEL 1 INSPECTION AND TESTING IN ACCORDANCE WITH AS3798-2007

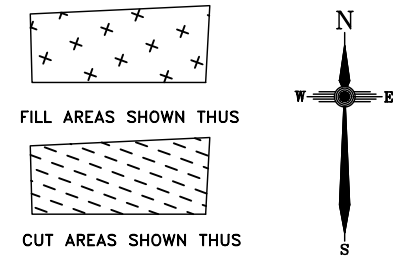

**Note**  
Contour interval is shown at 0.5 metres.

Revisions	Surveyed	Drawn	Checked	Passed	Date	
C	BFZ REMOVED	VERIS	JJ	AJP	AJP	09.04.24
B	BFZ DIMS	VERIS	JJ	AJP	AJP	28.04.23
A	ORIGINAL PLAN	VERIS	JJ	AJP	AJP	26.04.22

SUNSHINE COAST  
PO Box 1073, Buddina QLD 4575 Ph: (07) 5437 8555  
mail@dqsurvey.com ABN: 91 615 043 251  
www.dqsurvey.com ACN: 615 043 251  
WESTERN DOWNS

Signed   
Cadastral Surveyor/Director  
Date **26/04/2022**

Horiz. Datum MGA Z56 Vert. Datum AHD  
Origin MGA Origin PSM 157803  
RL 39.695 AHD

Locality: MOOLOOLAH VALLEY

Local Government: SUNSHINE COAST REGIONAL COUNCIL

SHEET 1 OF 1 Scale At A3 size

COMPUTER FILE 14368 DIS S14 Rev C  
DRAWING NUMBER 14368 DIS-405 REV. C

**DISCLOSURE PLAN**  
**FOR PROPOSED ALLOTMENT 405**  
Dated 26th April 2022

This plan shows details of proposed allotment 405 on the Proposal Plan PL204-E dated 26th June 2019 which complies with a Subdivision Application lodged with Sunshine Coast Regional Council, subject to conditions.

The area being proposed allotment 405 described as part of Lot 3 on RP158360 & Lot 201 on SP323179, and situated at King Road, Mooloolah Valley.  
The allotment contains an area of 1001 square metres, more or less.

DETAIL SURVEY COMPLETED BY VERIS  
PLAN 32267-DS01 Rev B 28/11/2018.  
ENGINEERING DESIGN BY EMPOWER  
ENGINEERS & PROJECT MANAGERS  
X-B00336 S14-Design  
DATED 22/04/2022.

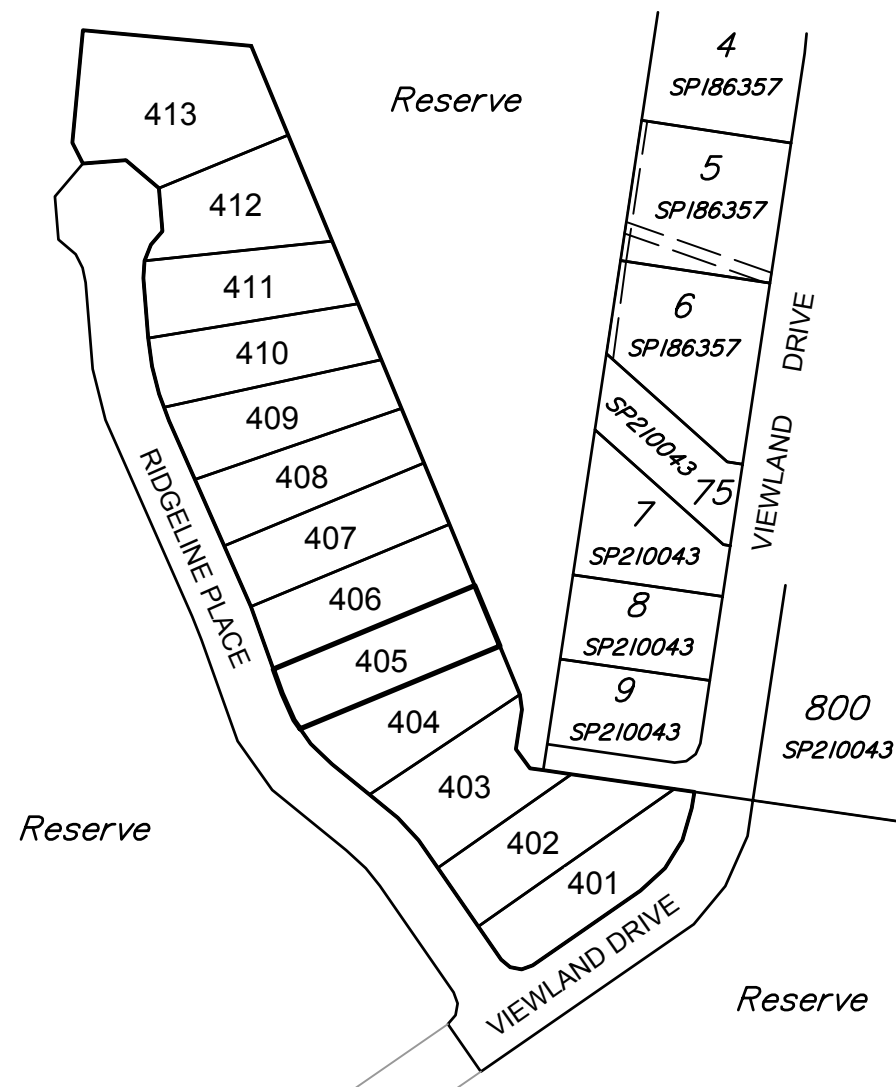

Scale 1:2000 - Lengths are in Metres.

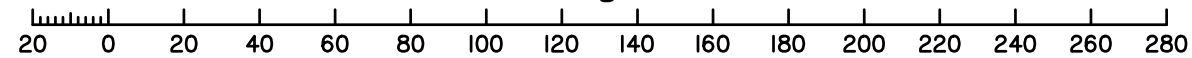

Scale 1:400 - Lengths are in Metres.

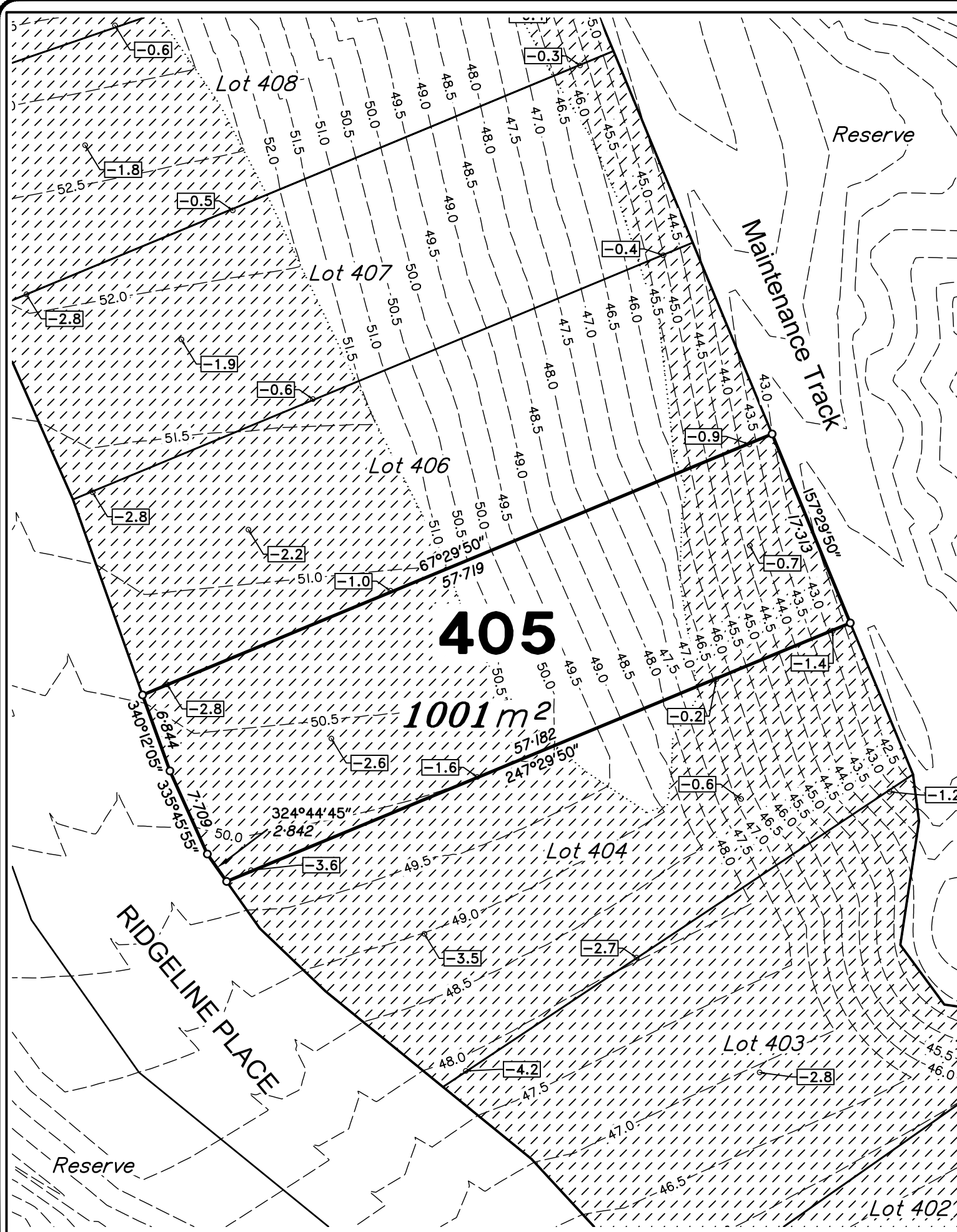
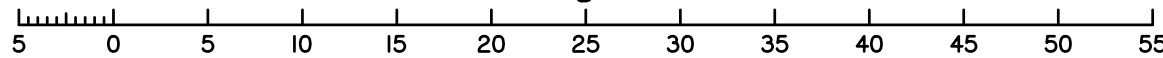

2024/04/09W: DSQ\_Data\Jobs\Current\14368 Urbex (Mooloolah Stages 3 & 4)\Data Survey\Drafting\Disclosures\14368 DIS S14 Rev C.dwg

**Disclosure Plan**  
**STAGE 4**  
**HILLSIDE**  
**MOOLOOLAH**  
King Road, Mooloolah  
**PROPOSED LOT 406**

**DISCLOSURE PLAN**  
**FOR PROPOSED ALLOTMENT 406**  
Dated 26th April 2022

This plan shows details of proposed allotment 406 on the Proposal Plan PL204-E dated 26th June 2019 which complies with a Subdivision Application lodged with Sunshine Coast Regional Council, subject to conditions.

The area being proposed allotment 406 described as part of Lot 3 on RP158360 & Lot 201 on SP323179, and situated at King Road, Mooloolah Valley.  
The allotment contains an area of 1005 square metres, more or less.

ALL FILL WITHIN ALLOTMENTS IS TO LEVEL 1 INSPECTION AND TESTING IN ACCORDANCE WITH AS3798-2007

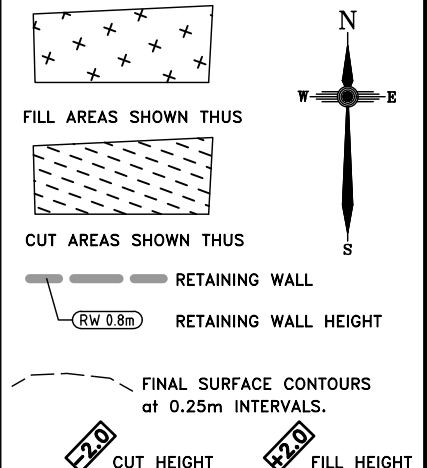

**Note**  
Contour interval is shown at 0.5 metres.

Revisions	Surveyed	Drawn	Checked	Passed	Date	
C	BFZ REMOVED	VERIS	JJ	AJP	AJP	09.04.24
B	BFZ DIMS	VERIS	JJ	AJP	AJP	28.04.23
A	ORIGINAL PLAN	VERIS	JJ	AJP	AJP	26.04.22



SUNSHINE COAST  
PO Box 1073, Buddina QLD 4575 Ph: (07) 5437 8555  
mail@dsqsurvey.com ABN: 91 615 043 251  
www.dsqsurvey.com ACN: 615 043 251  
WESTERN DOWNS

Signed   
Cadastral Surveyor/Director  
Date **26/04/2022**

Horiz. Datum MGA Z56 Vert. Datum AHD  
Origin MGA Origin PSM 157803  
RL 39.695 AHD

Locality: MOOLOOLAH VALLEY

Local Government: SUNSHINE COAST REGIONAL COUNCIL

SHEET 1 OF 1 Scale At A3 size

COMPUTER FILE 14368 DIS S14 Rev C

DRAWING NUMBER REV. **14368 DIS-406 C**

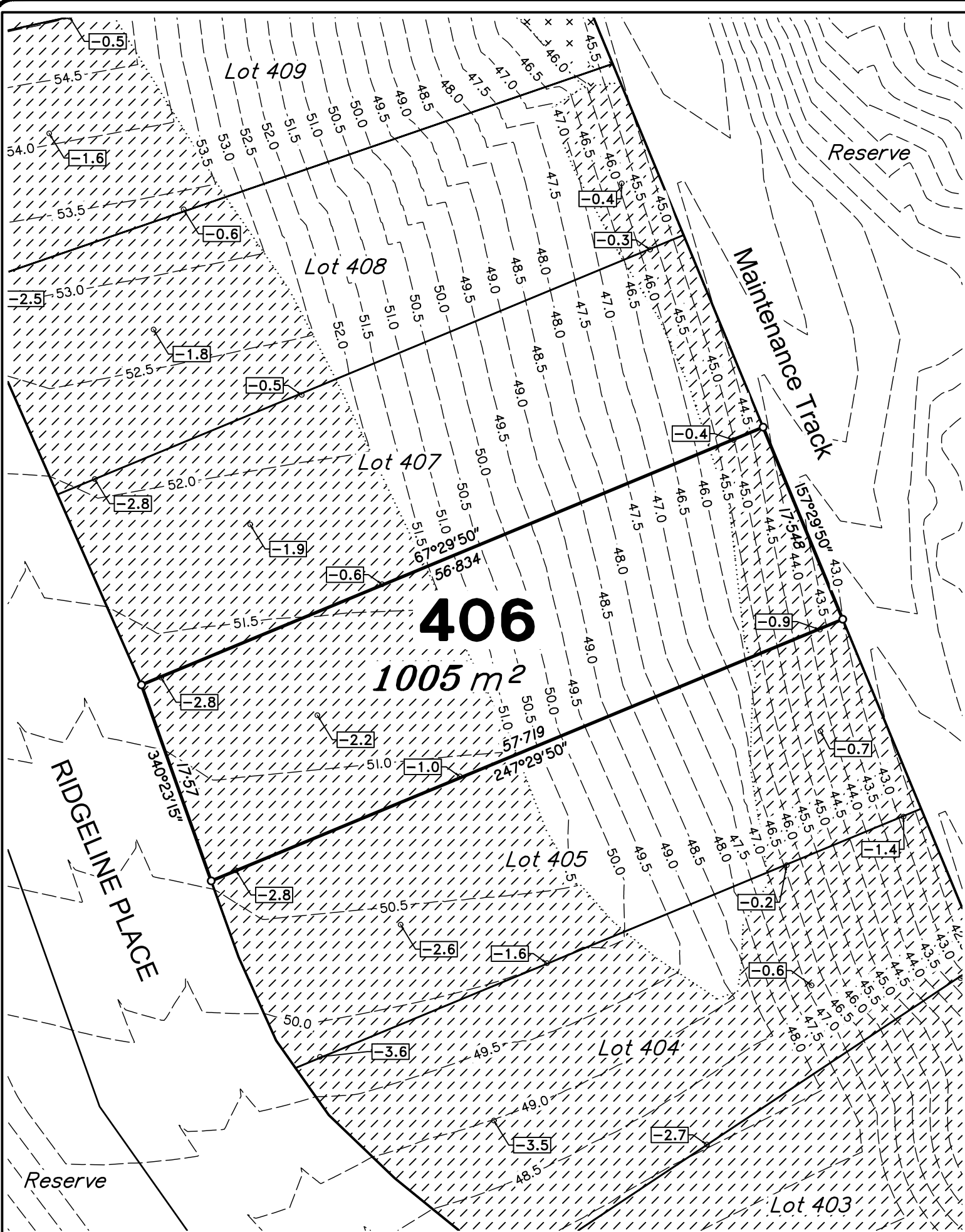

Scale 1:400 - Lengths are in Metres.

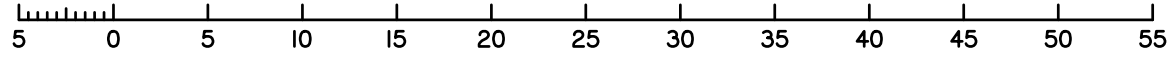

DETAIL SURVEY COMPLETED BY VERIS  
PLAN 32267-DS01 Rev B 28/11/2018.  
ENGINEERING DESIGN BY EMPOWER  
ENGINEERS & PROJECT MANAGERS  
X-B00336 S14-Design  
DATED 22/04/2022.

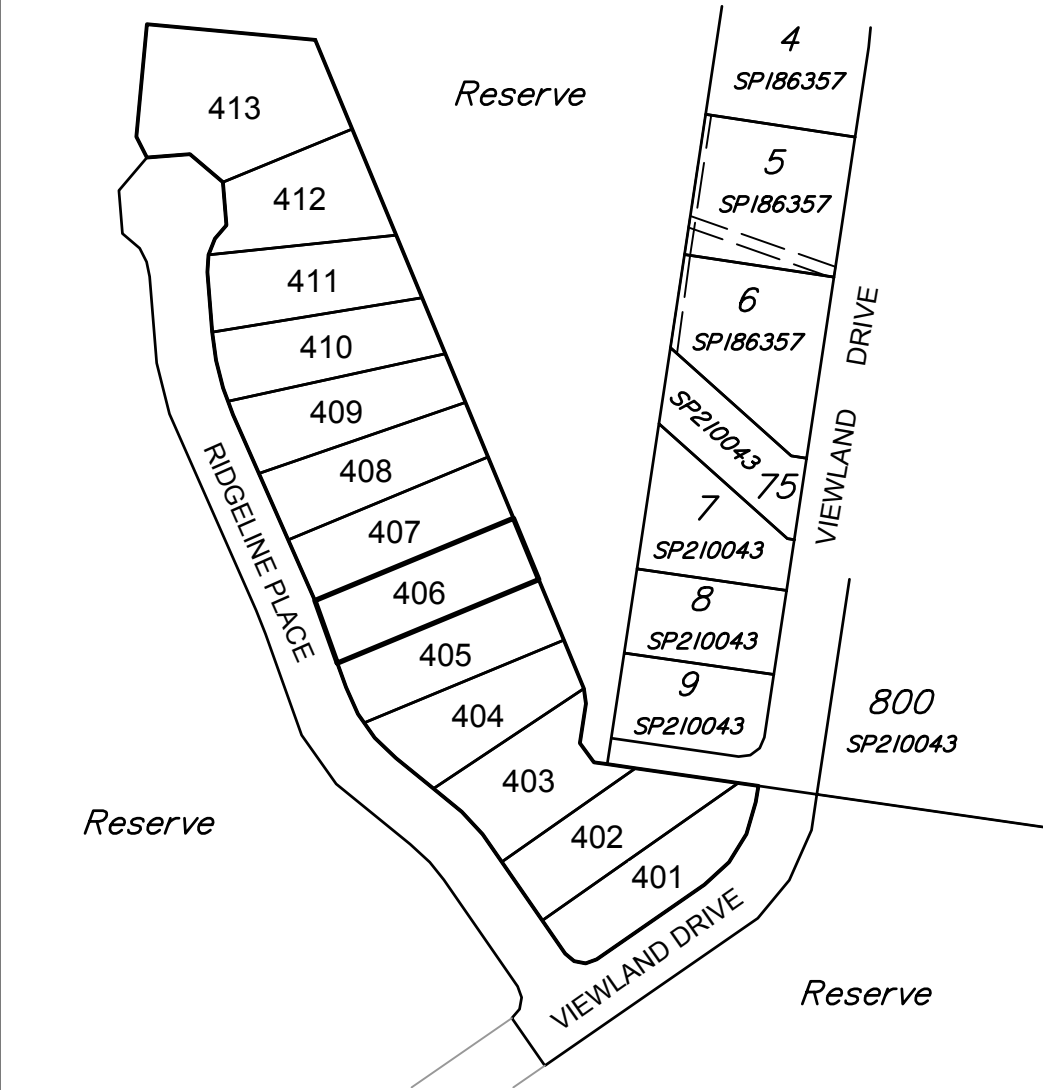

Scale 1:2000 - Lengths are in Metres.

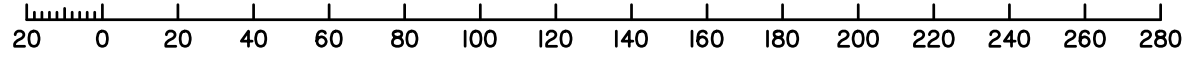

2024/04/09W:\DSQ\_Data\Jobs\Current\14368 Urban (Mooloolah Stages 3 & 4)\Data Survey\Drafting\Disclosures\14368 DIS S14 Rev C.dwg



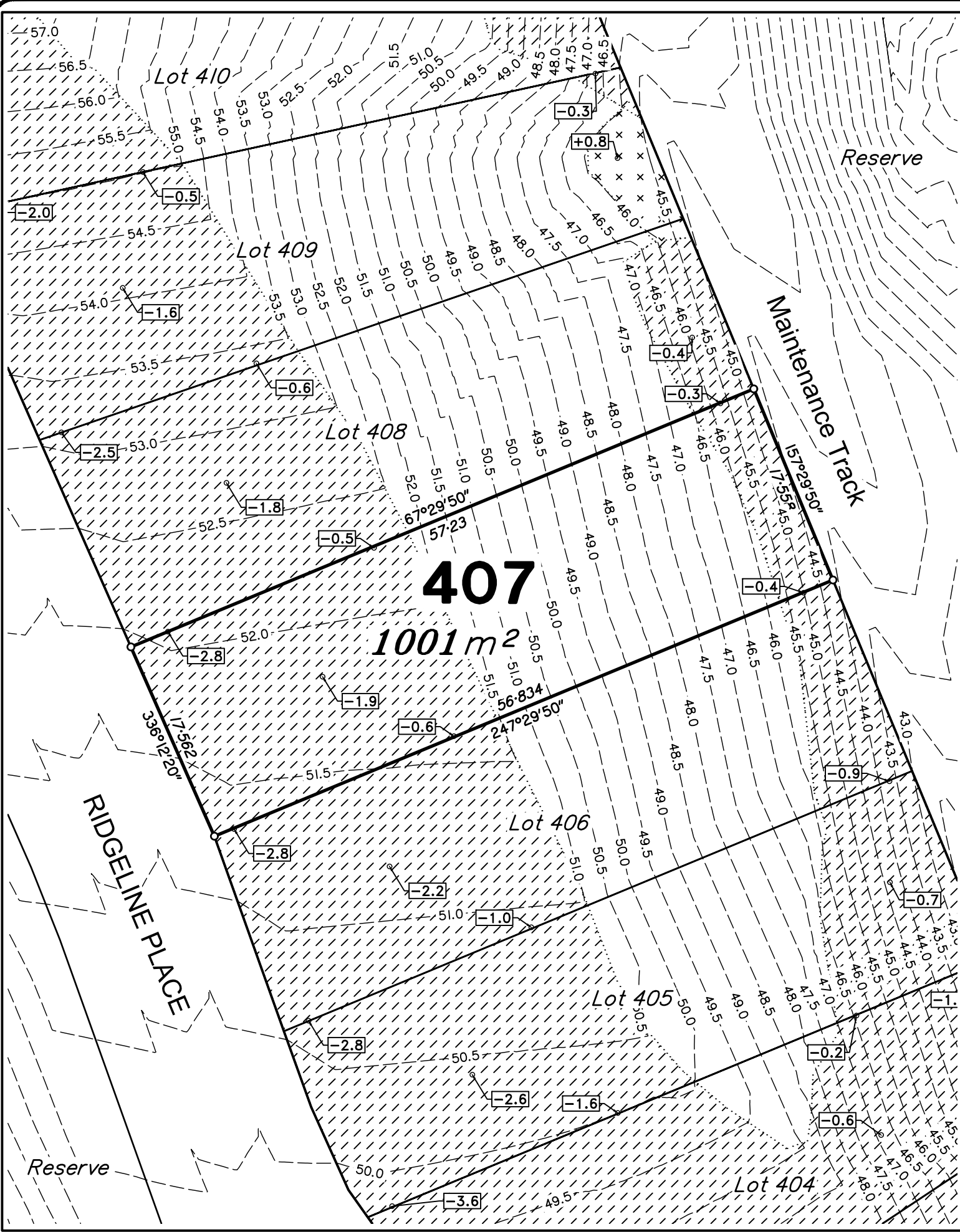

Scale 1:400 - Lengths are in Metres.

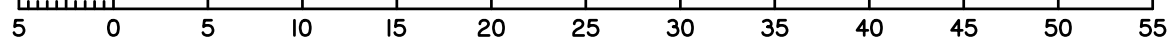

**DISCLOSURE PLAN**  
**FOR PROPOSED ALLOTMENT 407**  
 Dated 26th April 2022

This plan shows details of proposed allotment 407 on the Proposal Plan PL204-E dated 26th June 2019 which complies with a Subdivision Application lodged with Sunshine Coast Regional Council, subject to conditions.

The area being proposed allotment 407 described as part of Lot 3 on RP158360 & Lot 201 on SP323179, and situated at King Road, Mooloolah Valley.  
 The allotment contains an area of 1001 square metres, more or less.

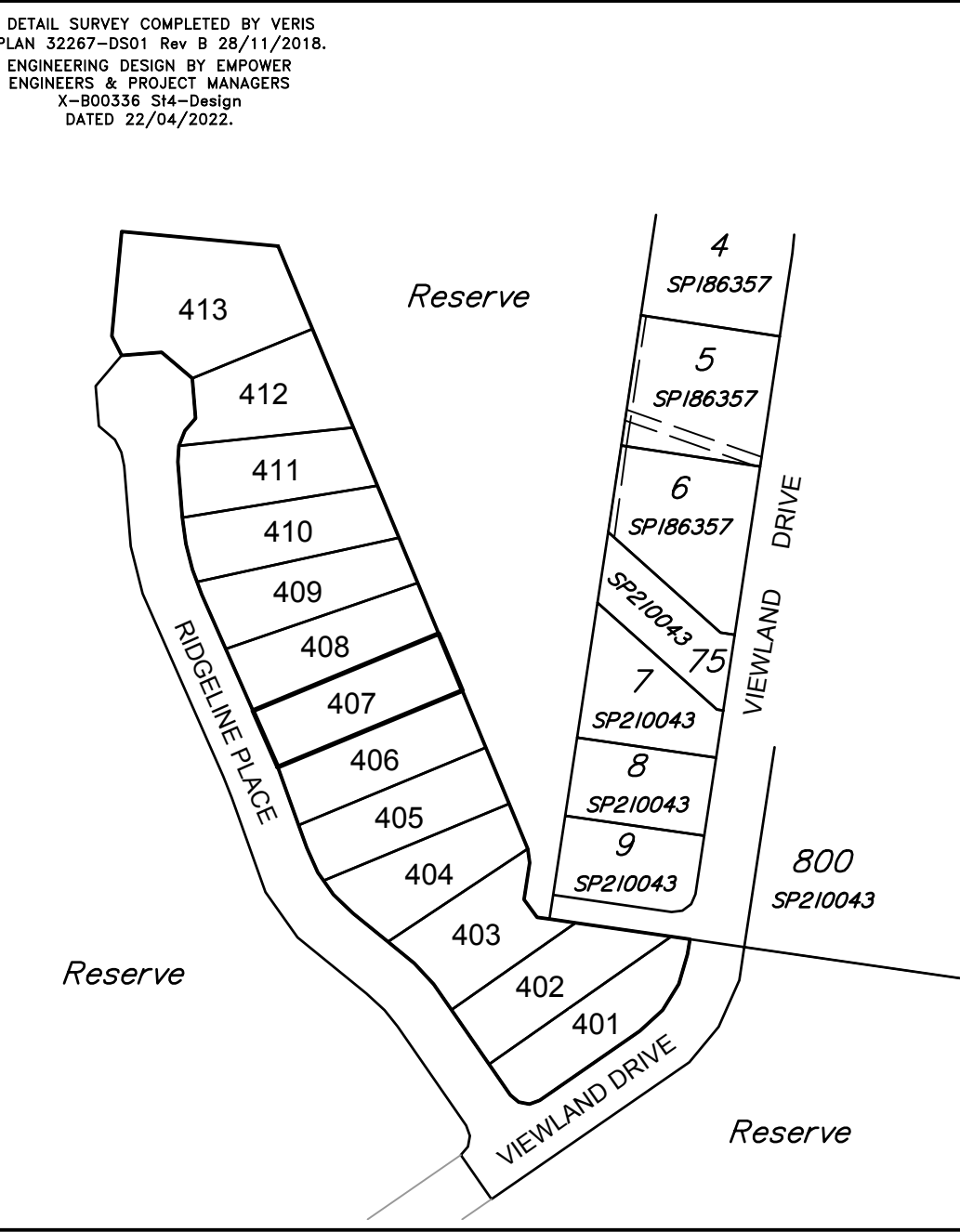

Scale 1:2000 - Lengths are in Metres.

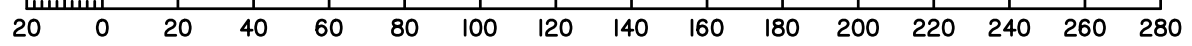

DETAIL SURVEY COMPLETED BY VERIS  
 PLAN 32267-DS01 Rev B 28/11/2018.  
 ENGINEERING DESIGN BY EMPOWER  
 ENGINEERS & PROJECT MANAGERS  
 X-B00336 St4-Design  
 DATED 22/04/2022.

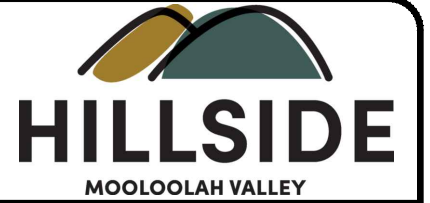

**Disclosure Plan**  
**STAGE 4**  
**HILLSIDE**  
**MOOLOOLAH**  
 King Road, Mooloolah  
**PROPOSED LOT 407**

ALL FILL WITHIN ALLOTMENTS IS TO LEVEL 1 INSPECTION AND TESTING IN ACCORDANCE WITH AS3798-2007

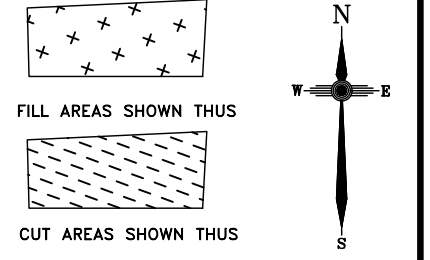

**Note**  
 Contour interval is shown at 0.5 metres.

Revisions	Surveyed	Drawn	Checked	Passed	Date	
C	BFZ REMOVED	VERIS	JJ	AJP	AJP	09.04.24
B	BFZ DIMS	VERIS	JJ	AJP	AJP	28.04.23
A	ORIGINAL PLAN	VERIS	JJ	AJP	AJP	26.04.22



SUNSHINE COAST  
 PO Box 1073, Buddina QLD 4575 Ph: (07) 5437 8555  
 mail@dsqsurvey.com ABN: 91 615 043 251  
 www.dsqsurvey.com ACN: 615 043 251  
 WESTERN DOWNS

Signed JB  
 Cadastral Surveyor/Director  
 Date 26/04/2022

Horiz. Datum MGA Z56 Vert. Datum AHD  
 Origin MGA Origin PSM 157803  
 RL 39.695 AHD

Locality: MOOLOOLAH VALLEY

Local Government: SUNSHINE COAST REGIONAL COUNCIL

SHEET 1 OF 1 Scale At A3 size

COMPUTER FILE 14368 DIS S14 Rev C  
 DRAWING NUMBER 14368 DIS-407 REV. C

2024/04/09W: DSQ\_Data\Jobs\Current\14368 Urbex (Mooloolah Stages 3 & 4)\Data Survey\Drafting\Disclosures\14368 DIS S14 Rev C.dwg

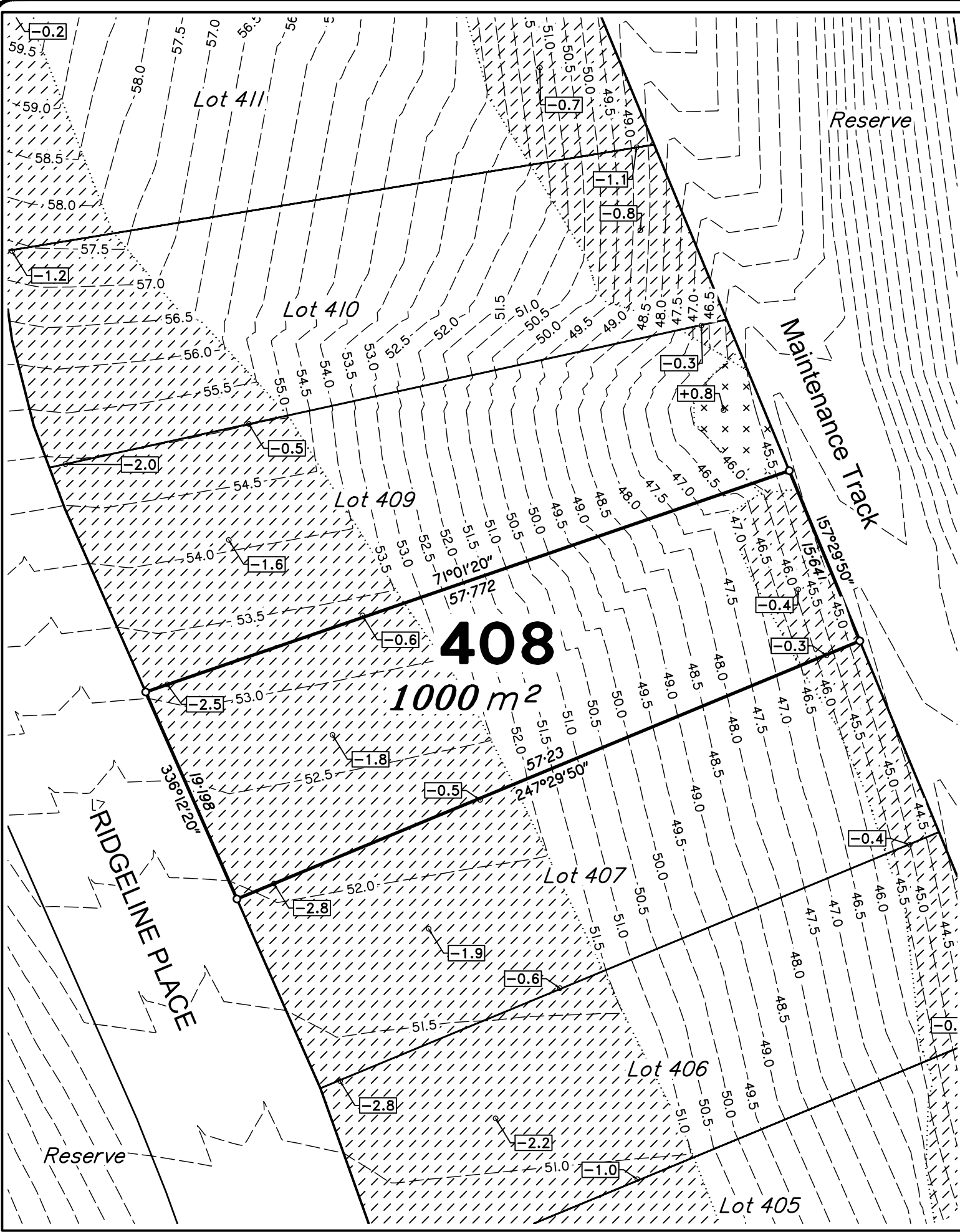

Scale 1:400 - Lengths are in Metres.

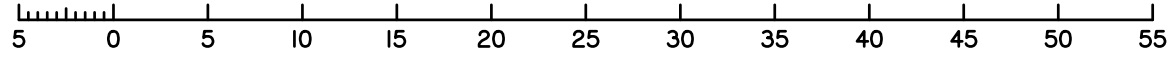

### DISCLOSURE PLAN FOR PROPOSED ALLOTMENT 408 Dated 26th April 2022

This plan shows details of proposed allotment 408 on the Proposal Plan PL204-E dated 26th June 2019 which complies with a Subdivision Application lodged with Sunshine Coast Regional Council, subject to conditions.

The area being proposed allotment 408 described as part of Lot 3 on RP158360 & Lot 201 on SP323179, and situated at King Road, Mooloolah Valley.  
The allotment contains an area of 1000 square metres, more or less.

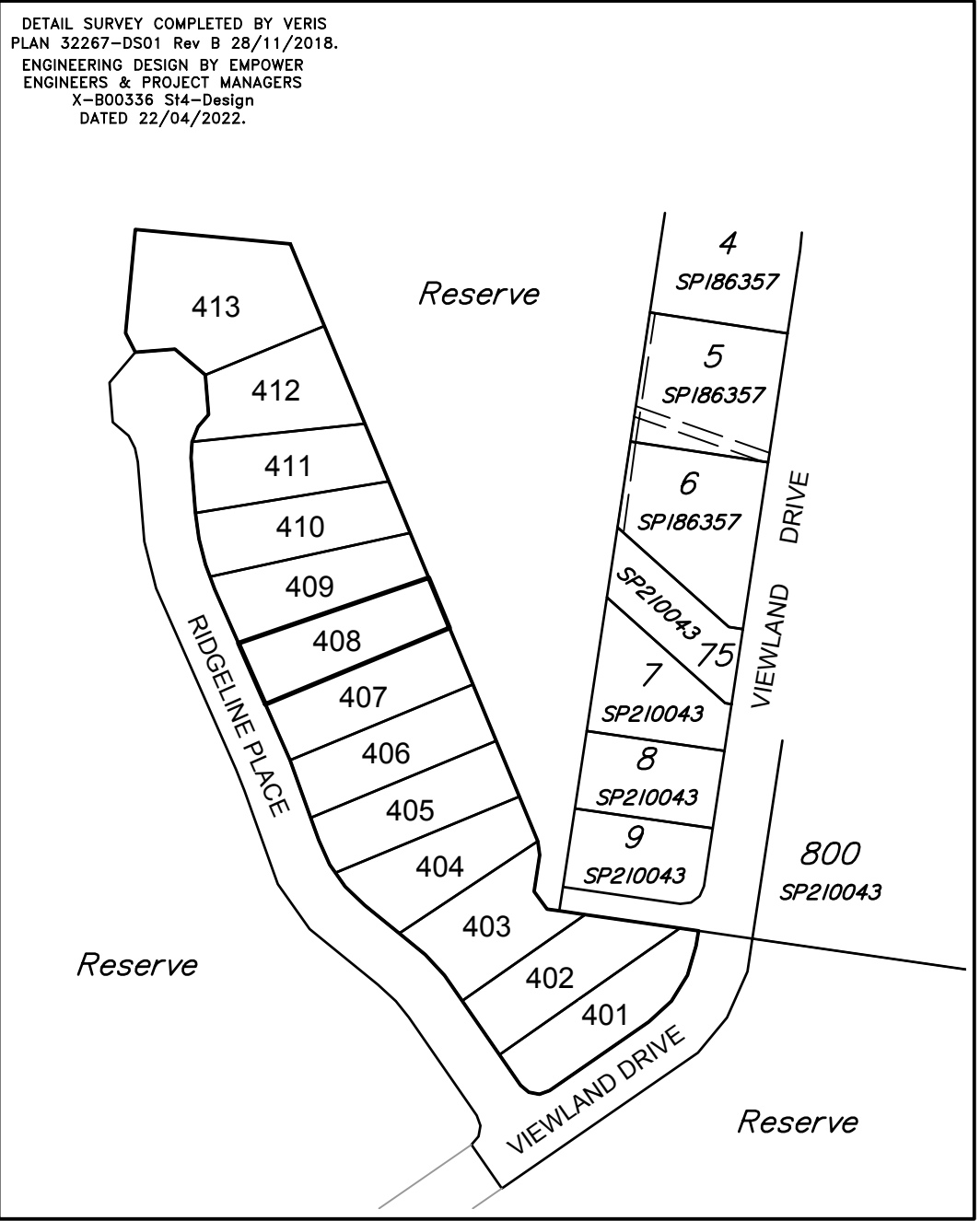

DETAIL SURVEY COMPLETED BY VERIS  
PLAN 32267-DS01 Rev B 28/11/2018.  
ENGINEERING DESIGN BY EMPOWER  
ENGINEERS & PROJECT MANAGERS  
X-B00336 St4-Design  
DATED 22/04/2022.

Scale 1:2000 - Lengths are in Metres.

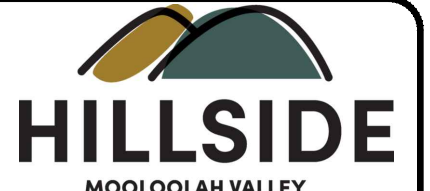
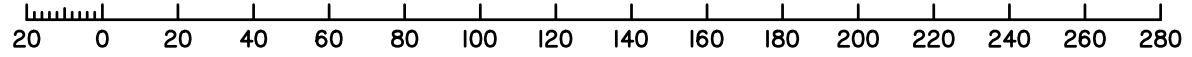

## Disclosure Plan STAGE 4 HILLSIDE MOOLOOLAH King Road, Mooloolah PROPOSED LOT 408

ALL FILL WITHIN ALLOTMENTS IS TO LEVEL 1 INSPECTION AND TESTING IN ACCORDANCE WITH AS3798-2007

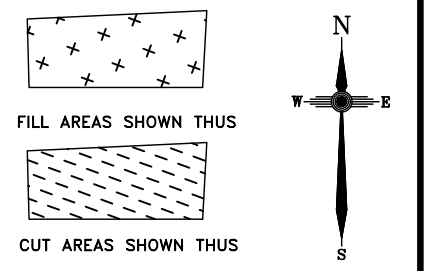

**Note**  
Contour interval is shown at 0.5 metres.

Revisions	Surveyed	Drawn	Checked	Passed	Date	
C	BFZ REMOVED	VERIS	JJ	AJP	AJP	09.04.24
B	BFZ DIMS	VERIS	JJ	AJP	AJP	28.04.23
A	ORIGINAL PLAN	VERIS	JJ	AJP	AJP	26.04.22

SUNSHINE COAST  
PO Box 1073, Buddina QLD 4575 Ph: (07) 5437 8555  
mail@dsqsurvey.com ABN: 91 615 043 251  
www.dsqsurvey.com ACN: 615 043 251  
WESTERN DOWNS

Signed JB  
Cadastral Surveyor/Director  
Date 26/04/2022

Horiz. Datum MGA Z56 Vert. Datum AHD  
Origin MGA Origin PSM 157803  
RL 39.695 AHD  
Locality: MOOLOOLAH VALLEY  
Local Government: SUNSHINE COAST REGIONAL COUNCIL

SHEET 1 OF 1 Scale At A3 size  
COMPUTER FILE 14368 DIS S14 Rev C  
DRAWING NUMBER 14368 DIS-408 REV. C

2024/04/09w: DSQ\_Data\Jobs\Current\Mooloolah Stages 3 & 4\Data Survey\Drafting\Disclosures\14368 DIS S14 Rev C.dwg



**Disclosure Plan**  
**STAGE 4**  
**HILLSIDE**  
**MOOLOOLAH**  
King Road, Mooloolah  
**PROPOSED LOT 409**

**DISCLOSURE PLAN**  
**FOR PROPOSED ALLOTMENT 409**  
Dated 26th April 2022

This plan shows details of proposed allotment 409 on the Proposal Plan PL204-E dated 26th June 2019 which complies with a Subdivision Application lodged with Sunshine Coast Regional Council, subject to conditions.

The area being proposed allotment 409 described as part of Lot 3 on RP158360 & Lot 201 on SP323179, and situated at King Road, Mooloolah Valley.  
The allotment contains an area of 1001 square metres, more or less.

ALL FILL WITHIN ALLOTMENTS IS TO LEVEL 1 INSPECTION AND TESTING IN ACCORDANCE WITH AS3798-2007

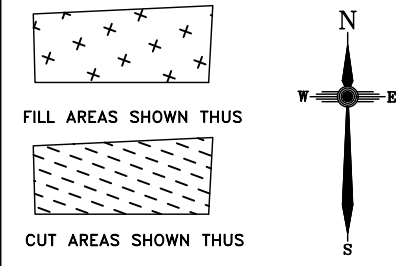

**Note**  
Contour interval is shown at 0.5 metres.

Revisions	Surveyed	Drawn	Checked	Passed	Date	
C	BFZ REMOVED	VERIS	JJ	AJP	AJP	09.04.24
B	BFZ DIMS	VERIS	JJ	AJP	AJP	28.04.23
A	ORIGINAL PLAN	VERIS	JJ	AJP	AJP	26.04.22

**DSQ**  
LAND SURVEYORS

SUNSHINE COAST  
PO Box 1073, Buddina QLD 4575 Ph: (07) 5437 8555  
mail@dsqsurvey.com ABN: 91 615 043 251  
www.dsqsurvey.com ACN: 615 043 251  
WESTERN DOWNS

Signed   
Cadastral Surveyor/Director

Date **26/04/2022**

Horiz. Datum MGA Z56 Vert. Datum AHD  
Origin MGA Origin PSM 157803  
RL 39.695 AHD

Locality: MOOLOOLAH VALLEY

Local Government: SUNSHINE COAST REGIONAL COUNCIL

SHEET 1 OF 1 Scale At A3 size

COMPUTER FILE 14368 DIS S14 Rev C

DRAWING NUMBER **14368 DIS-409** REV. **C**

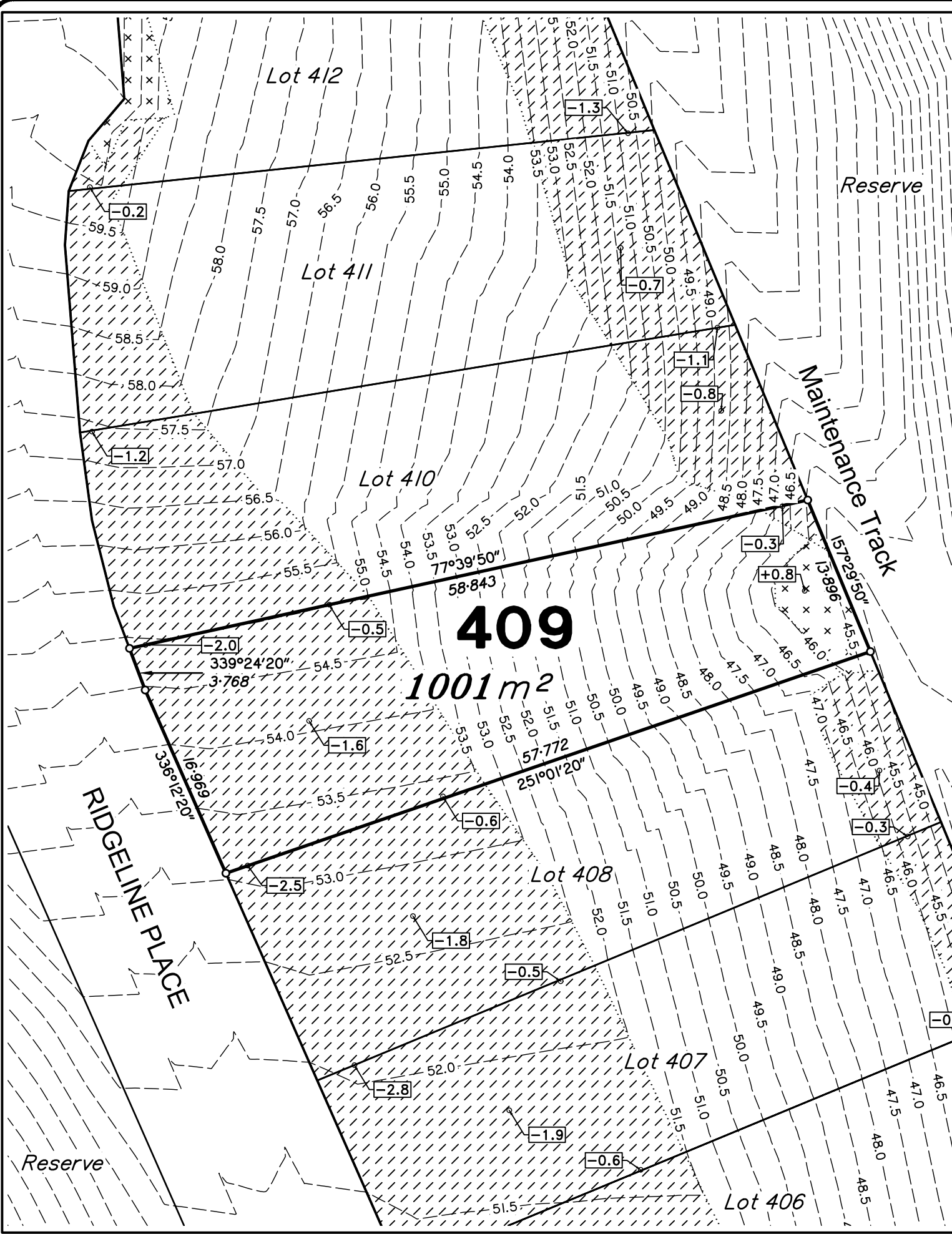

Scale 1:400 - Lengths are in Metres.

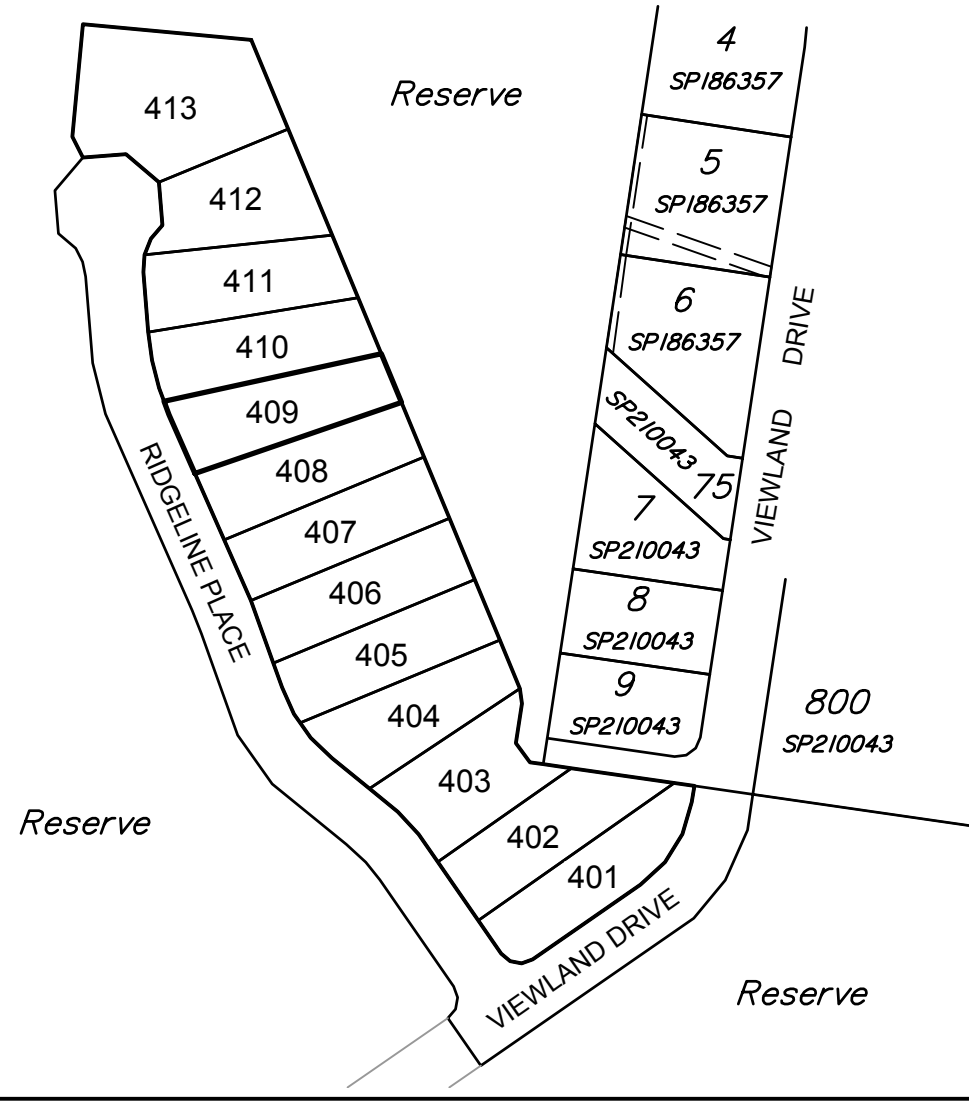
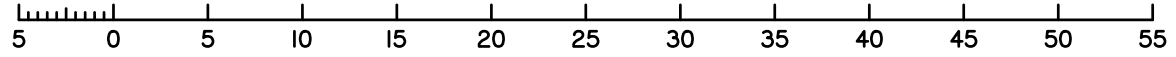

Scale 1:2000 - Lengths are in Metres.

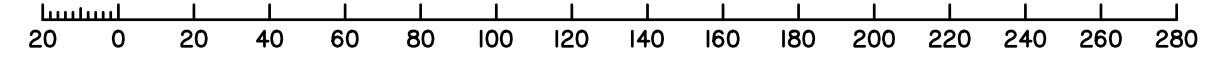

DETAIL SURVEY COMPLETED BY VERIS  
PLAN 32267-DS01 Rev B 28/11/2018.  
ENGINEERING DESIGN BY EMPOWER  
ENGINEERS & PROJECT MANAGERS  
X-B00336 S14-Design  
DATED 22/04/2022.

2024/04/09W: DSQ\_Data\Jobs\Current\14368 Urban (Mooloolah Stages 3 & 4)\Data Survey\Drafting\Disclosures\14368 DIS S14 Rev C.dwg

**Disclosure Plan**  
**STAGE 4**  
**HILLSIDE**  
**MOOLOOLAH**  
King Road, Mooloolah  
**PROPOSED LOT 410**

**DISCLOSURE PLAN**  
**FOR PROPOSED ALLOTMENT 410**  
Dated 26th April 2022

This plan shows details of proposed allotment 410 on the Proposal Plan PL204-E dated 26th June 2019 which complies with a Subdivision Application lodged with Sunshine Coast Regional Council, subject to conditions.

The area being proposed allotment 410 described as part of Lot 3 on RP158360 & Lot 201 on SP323179, and situated at King Road, Mooloolah Valley.  
The allotment contains an area of 1001 square metres, more or less.

ALL FILL WITHIN ALLOTMENTS IS TO LEVEL 1 INSPECTION AND TESTING IN ACCORDANCE WITH AS3798-2007

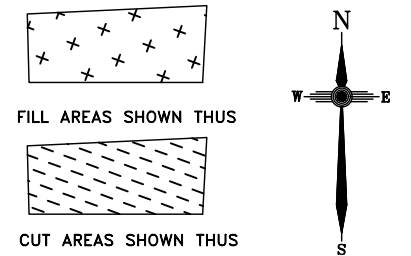

**Note**  
Contour interval is shown at 0.5 metres.

Revisions	Surveyed	Drawn	Checked	Passed	Date	
C	BFZ REMOVED	VERIS	JJ	AJP	AJP	09.04.24
B	BFZ DIMS	VERIS	JJ	AJP	AJP	28.04.23
A	ORIGINAL PLAN	VERIS	JJ	AJP	AJP	28.04.22

**DSQ**  
LAND SURVEYORS

SUNSHINE COAST  
PO Box 1073, Buddina QLD 4575 Ph: (07) 5437 8555  
mail@dsqsurvey.com ABN: 91 615 043 251  
www.dsqsurvey.com ACN: 615 043 251  
WESTERN DOWNS

Signed   
Cadastral Surveyor/Director

Date **26/04/2022**

Horiz. Datum MGA Z56 Vert. Datum AHD  
Origin MGA Origin PSM 157803  
RL 39.695 AHD

Locality: MOOLOOLAH VALLEY

Local Government: SUNSHINE COAST REGIONAL COUNCIL

SHEET 1 OF 1 Scale At A3 size

COMPUTER FILE 14368 DIS S14 Rev C

DRAWING NUMBER **14368 DIS-410** REV. **C**

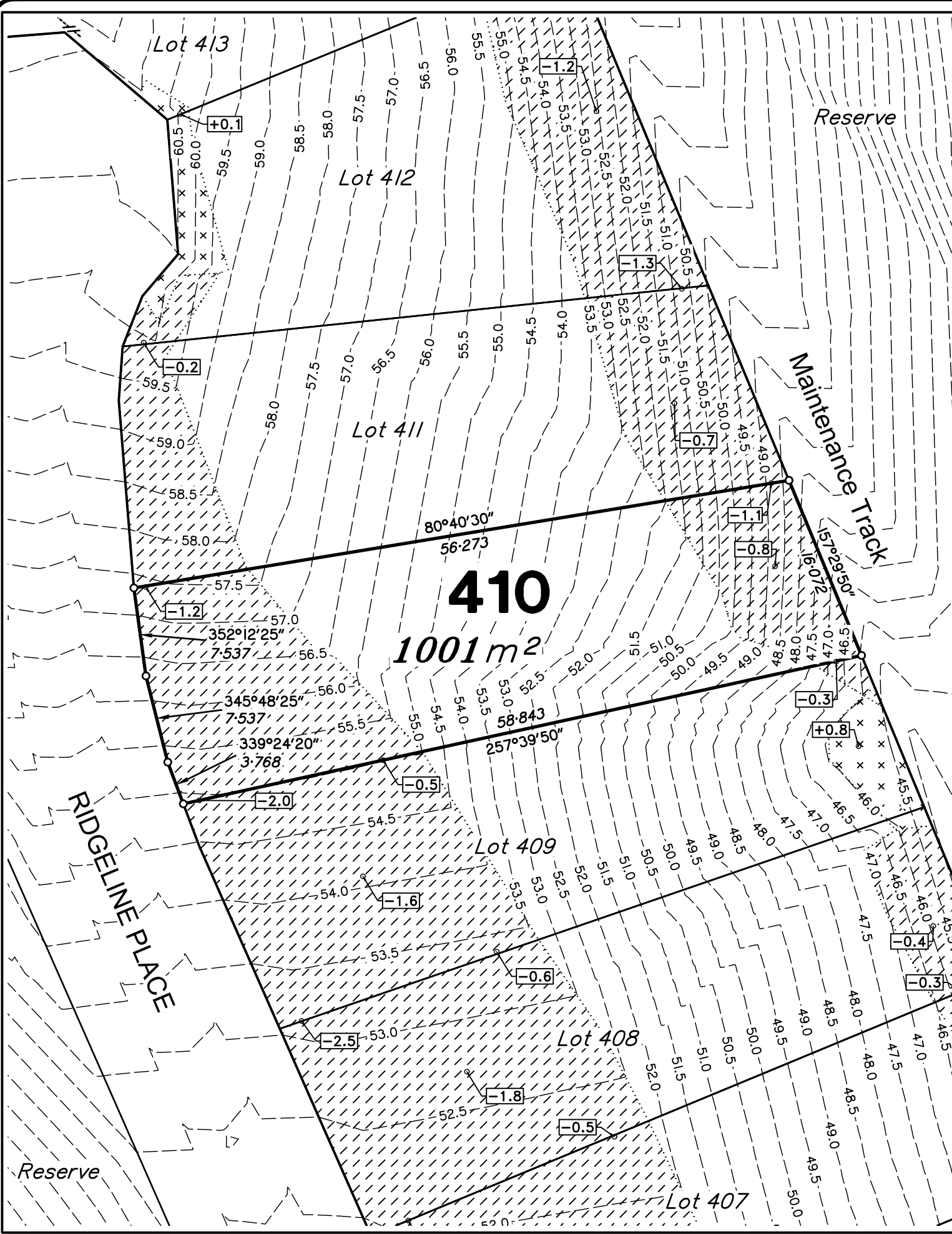

Scale 1:400 - Lengths are in Metres.

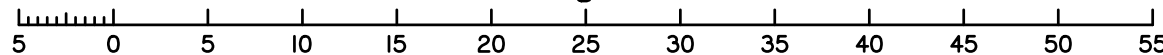

DETAIL SURVEY COMPLETED BY VERIS  
PLAN 32267-DS01 Rev B 28/11/2018.  
ENGINEERING DESIGN BY EMPOWER  
ENGINEERS & PROJECT MANAGERS  
X-B00336 S14-Design  
DATED 22/04/2022.

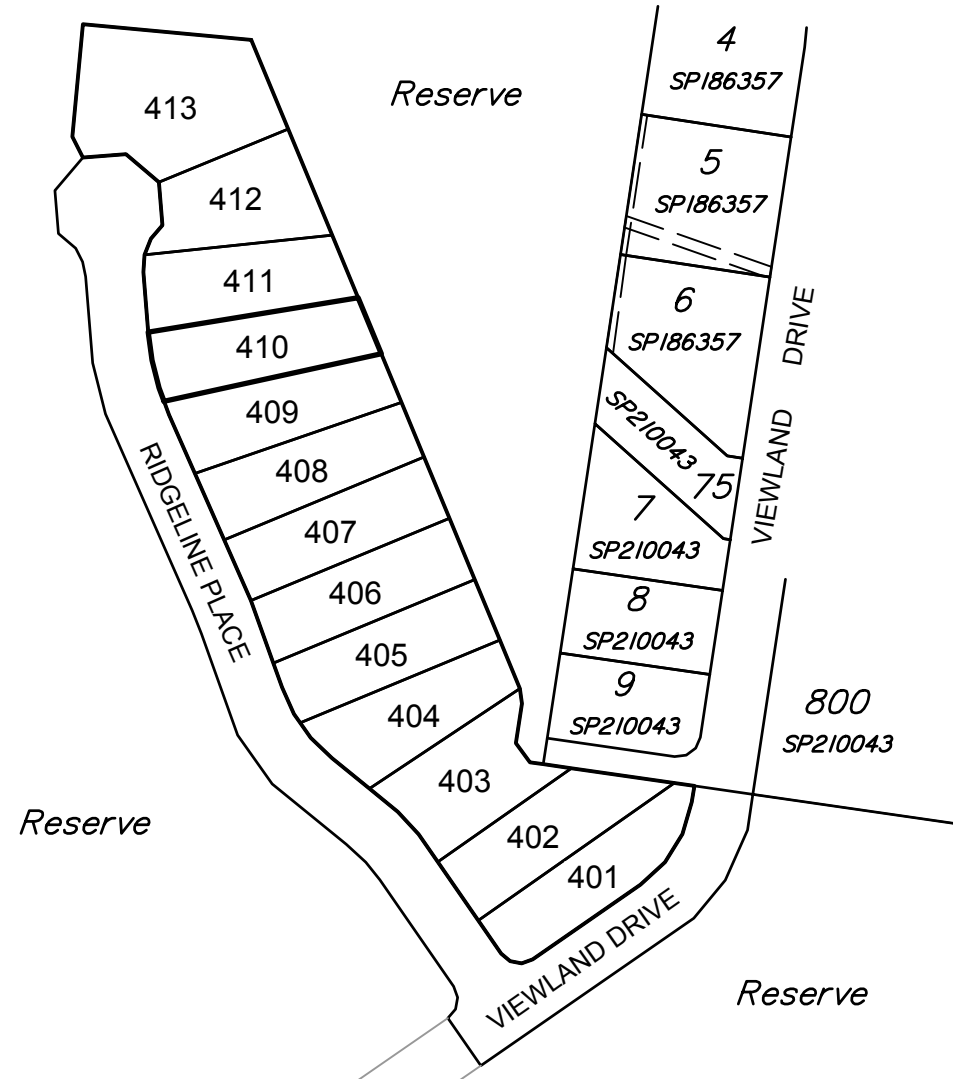

Scale 1:2000 - Lengths are in Metres.

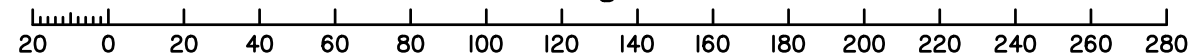

2024/04/09W: DSQ\_Data\Jobs\Current\14368 Urban (Mooloolah Stages 3 & 4)\Data Survey\Drafting\Disclosures\14368 DIS S14 Rev C.dwg



Bushfire Separation Zone

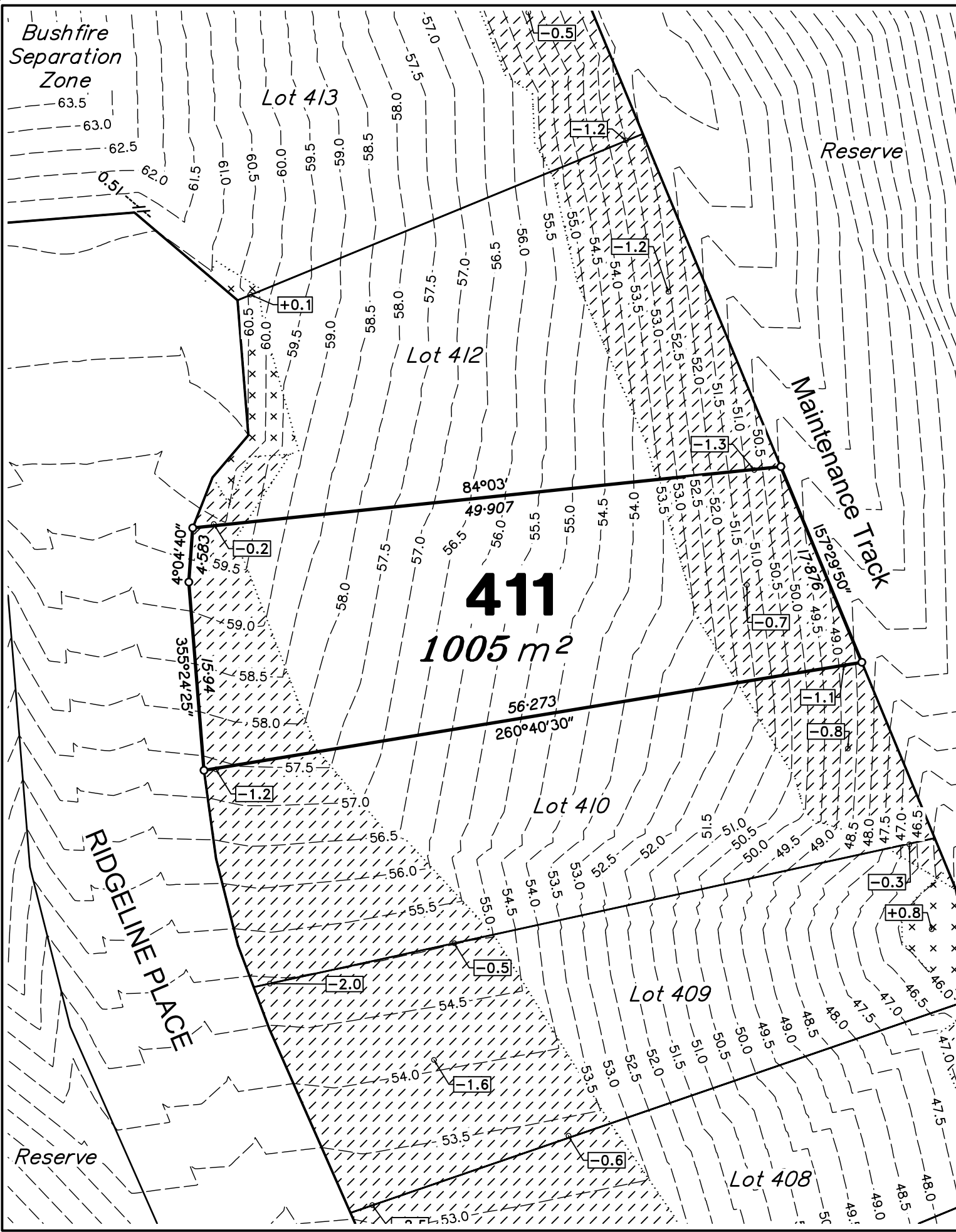

Scale 1:400 - Lengths are in Metres.

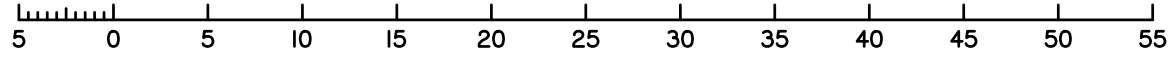

## DISCLOSURE PLAN FOR PROPOSED ALLOTMENT 411 Dated 26th April 2022

This plan shows details of proposed allotment 411 on the Proposal Plan PL204-E dated 26th June 2019 which complies with a Subdivision Application lodged with Sunshine Coast Regional Council, subject to conditions.

The area being proposed allotment 411 described as part of Lot 3 on RP158360 & Lot 201 on SP323179, and situated at King Road, Mooloolah Valley.  
The allotment contains an area of 1005 square metres, more or less.

DETAIL SURVEY COMPLETED BY VERIS  
PLAN 32267-DS01 Rev B 28/11/2018.  
ENGINEERING DESIGN BY EMPOWER  
ENGINEERS & PROJECT MANAGERS  
X-B00336 St4-Design  
DATED 22/04/2022.

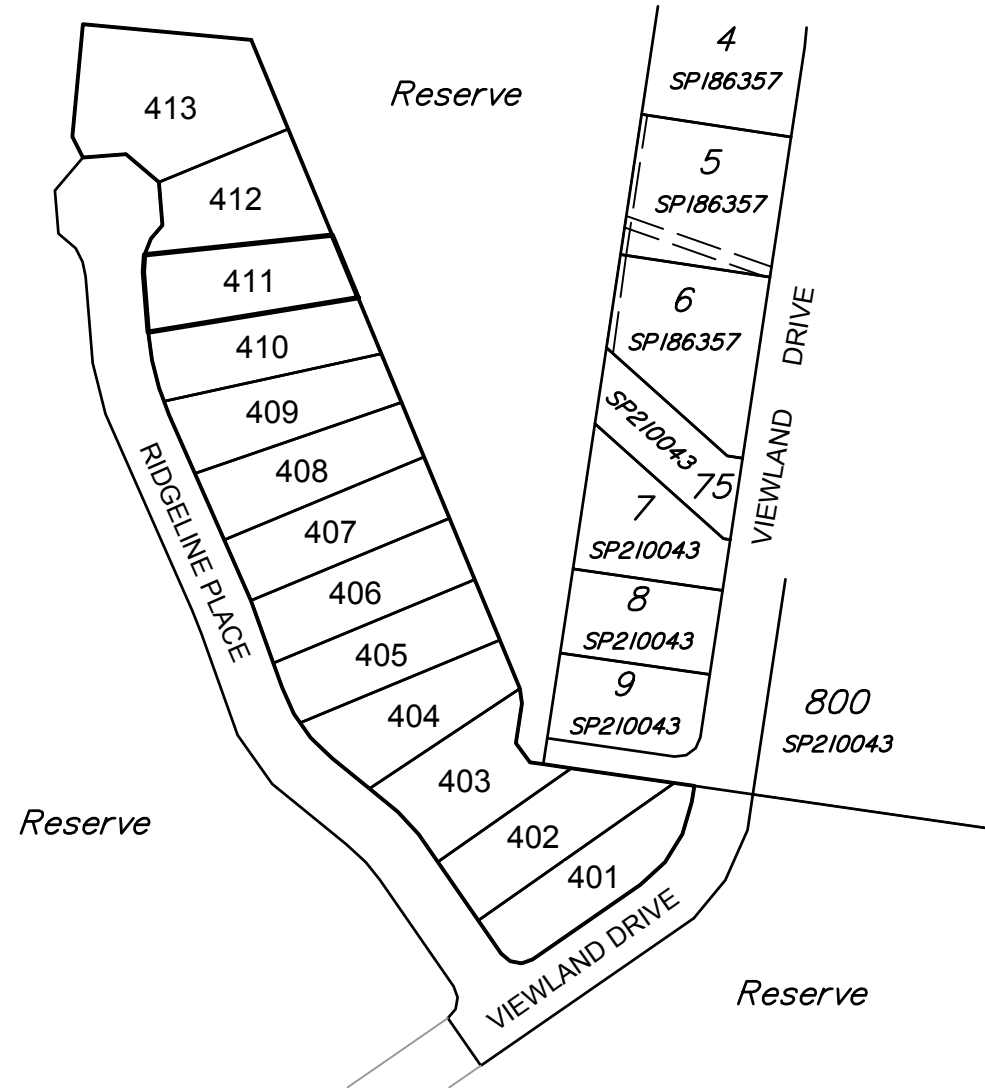

Scale 1:2000 - Lengths are in Metres.

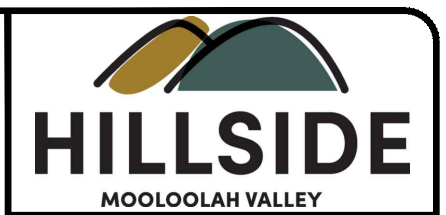
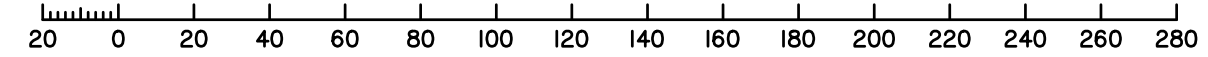

### Disclosure Plan STAGE 4 HILLSIDE MOOLOOLAH King Road, Mooloolah PROPOSED LOT 411

ALL FILL WITHIN ALLOTMENTS IS TO LEVEL 1 INSPECTION AND TESTING IN ACCORDANCE WITH AS3798-2007

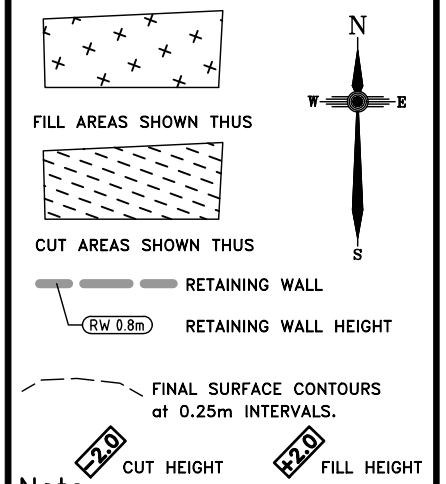

Note  
Contour interval is shown at 0.5 metres.

Revisions	Surveyed	Drawn	Checked	Passed	Date	
C	BFZ REMOVED	VERIS	JJ	AJP	AJP	09.04.24
B	BFZ DIMS	VERIS	JJ	AJP	AJP	28.04.23
A	ORIGINAL PLAN	VERIS	JJ	AJP	AJP	26.04.22



SUNSHINE COAST  
PO Box 1073, Buddina QLD 4575 Ph: (07) 5437 8555  
mail@dqsurvey.com ABN: 91 615 043 251  
www.dqsurvey.com ACN: 615 043 251  
WESTERN DOWNS

Signed JB  
Cadastral Surveyor/Director  
Date 26/04/2022

Horiz. Datum MGA Z56 Vert. Datum AHD  
Origin MGA Origin PSM 157803  
RL 39.695 AHD

Locality: MOOLOOLAH VALLEY  
Local Government: SUNSHINE COAST REGIONAL COUNCIL

SHEET 1 OF 1 Scale At A3 size  
COMPUTER FILE 14368 DIS St4 Rev C

DRAWING NUMBER 14368 DIS-411 REV. C

2024/04/09W: DSO\_Data \Jobs \Current \Mooloolah Stages 3 & 4 \Data Survey \Drafting \Disclosures \14368 DIS St4 Rev C.dwg

**Disclosure Plan**  
**STAGE 4**  
**HILLSIDE**  
**MOOLOOLAH**  
**King Road, Mooloolah**  
**PROPOSED LOT 412**

**DISCLOSURE PLAN**  
**FOR PROPOSED ALLOTMENT 412**  
 Dated 26th April 2022

This plan shows details of proposed allotment 412 on the Proposal Plan PL204-E dated 26th June 2019 which complies with a Subdivision Application lodged with Sunshine Coast Regional Council, subject to conditions.

The area being proposed allotment 412 described as part of Lot 3 on RP158360 & Lot 201 on SP323179, and situated at King Road, Mooloolah Valley.  
 The allotment contains an area of 1003 square metres, more or less.

ALL FILL WITHIN ALLOTMENTS IS TO LEVEL 1 INSPECTION AND TESTING IN ACCORDANCE WITH AS3798-2007

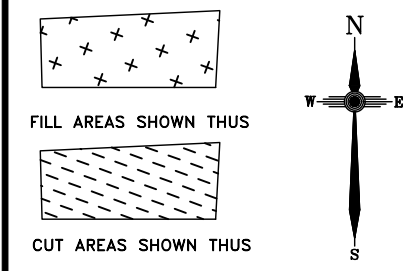

**Note**  
 Contour interval is shown at 0.5 metres.

Revisions	Surveyed	Drawn	Checked	Passed	Date	
C	BFZ REMOVED	VERIS	JJ	AJP	AJP	09.04.24
B	BFZ DIMS	VERIS	JJ	AJP	AJP	28.04.23
A	ORIGINAL PLAN	VERIS	JJ	AJP	AJP	28.04.22

**DSQ LAND SURVEYORS**  
 SUNSHINE COAST  
 PO Box 1073, Buddina QLD 4575 Ph: (07) 5437 8555  
 mail@dsqsurvey.com ABN: 91 615 043 251  
 www.dsqsurvey.com ACN: 615 043 251  
 WESTERN DOWNS

Signed JB  
 Cadastral Surveyor/Director  
 Date 26/04/2022

Horiz. Datum MGA Z56 Vert. Datum AHD  
 Origin MGA Origin PSM 157803  
 RL 39.695 AHD

Locality: MOOLOOLAH VALLEY  
 Local Government: SUNSHINE COAST REGIONAL COUNCIL

SHEET 1 OF 1 Scale At A3 size  
 COMPUTER FILE 14368 DIS S14 Rev C  
 DRAWING NUMBER 14368 DIS-412 REV. C

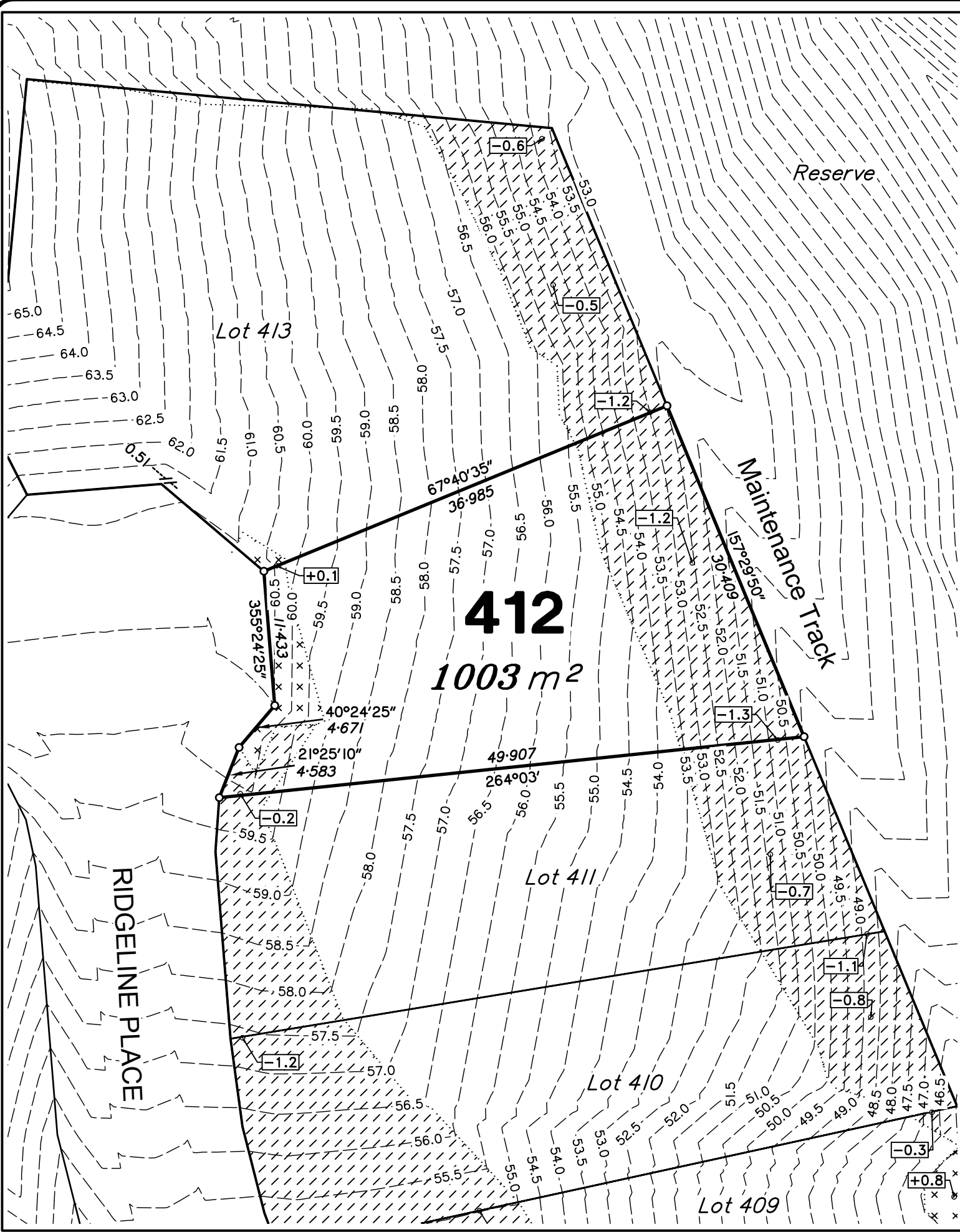

DETAIL SURVEY COMPLETED BY VERIS  
 PLAN 32267-DS01 Rev B 28/11/2018.  
 ENGINEERING DESIGN BY EMPOWER  
 ENGINEERS & PROJECT MANAGERS  
 X-B00336 S14-Design  
 DATED 22/04/2022.

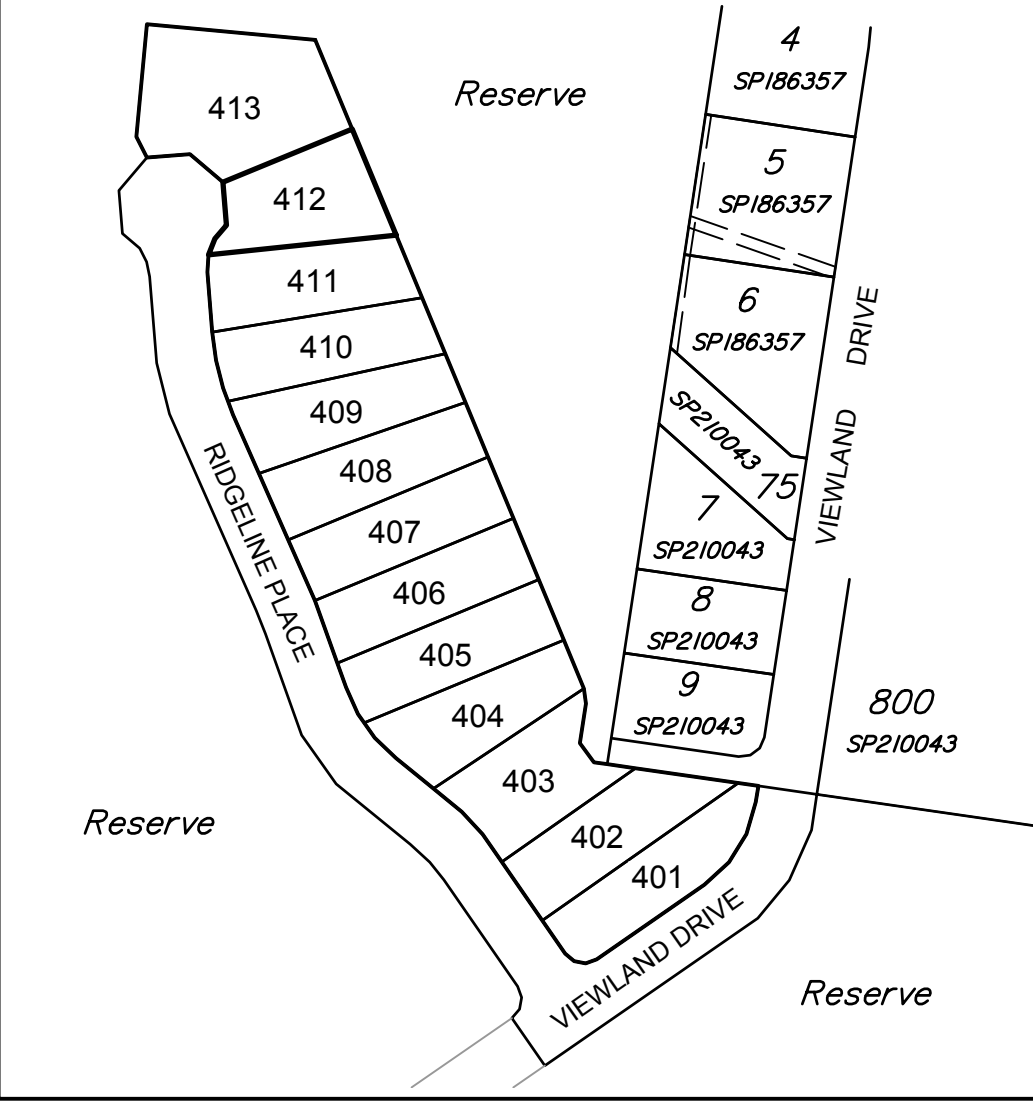

Scale 1:400 - Lengths are in Metres.

Scale 1:2000 - Lengths are in Metres.

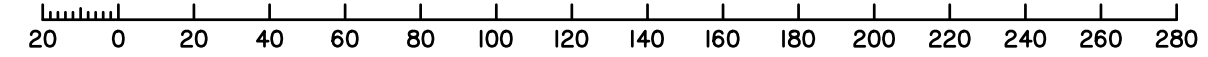
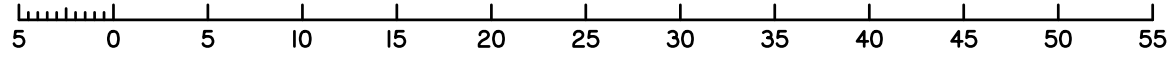

2024/04/09W:\DSQ\_Data\Jobs\Jobs Current\14368 Urban (Mooloolah Stages 3 & 4)\Data Survey\Drafting\Disclosures\14368 DIS S14 Rev C.dwg



